

DETAILS

Product Number	C15986_STRADELLA-8-HV-VSM
Family	Stradella
Type	Lens array
Color	clear
Diameter	49,5+49,5 mm
Height	5,5 mm
Style	rectang
Optic Material	PMMA
Holder Material	
Fastening	pin, screw
Status	production ready
ROHS Compliant	Yes
Date Updated	18/08/2017



OPTICAL PROPERTIES

LED	Viewing Angle	Light Beam	Efficiency	cd/lm	Connector
XT-E	147 deg	Wide-Area...	94 %	0.420	-
XP-G2	sim: 152	Wide-Area...	sim: 94 %	sim: 0.440	-
XD16	136 deg	Wide-Area...	-	94.000	-
XP-G3	sim: 152	Wide-Area...	sim: 94 %	sim: 0.360	-
LUXEON 3535 2D	sim: 143	Wide-Area...	sim: 94 %	sim: 0.490	-
LUXEON 3030 2D	137 deg	Wide-Area...	94 %	0.530	-
LUXEON FlipChip White 10	sim: 136	Wide-Area...	sim: 89 %	sim: 0.440	-
NF2x757D	sim: 140	Wide-Area...	sim: 94 %	sim: 0.560	-
NVSW219D	145 deg	Wide-Area...	94 %	0.400	-
Oslon Square Gen3	sim: 144	Wide-Area...	sim: 94 %	sim: 0.480	-
LH181A	sim: 150	Wide-Area...	sim: 94 %	sim: 0.400	-
LH181B	sim: 140	Wide-Area...	sim: 94 %	sim: 0.450	-

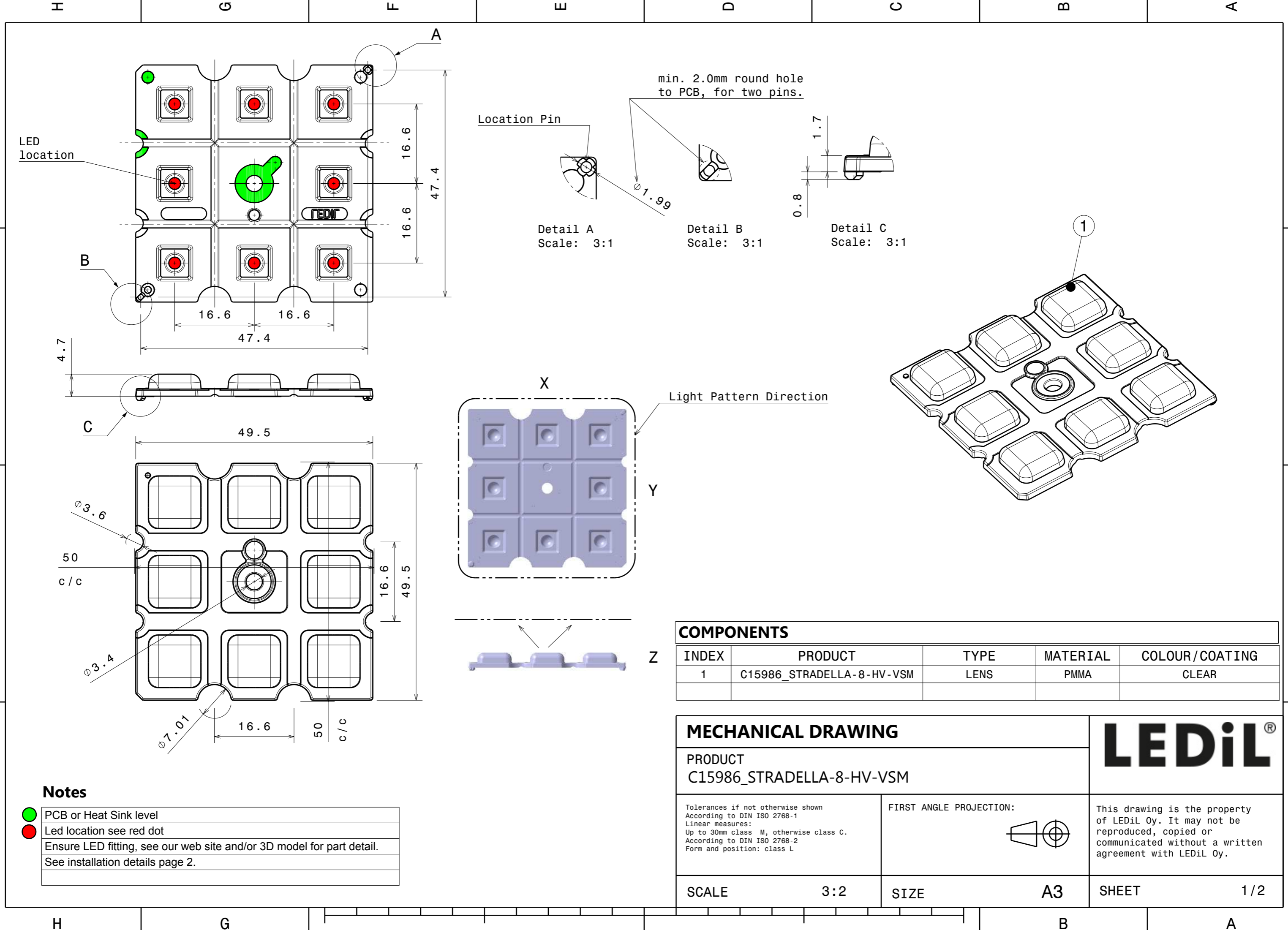

LED location

Location Pin

min. 2.0mm round hole to PCB, for two pins.

Detail A Scale: 3:1

Detail B Scale: 3:1

Detail C Scale: 3:1

Light Pattern Direction

COMPONENTS

INDEX	PRODUCT	TYPE	MATERIAL	COLOUR/COATING
1	C15986_STRADELLA-8-HV-VSM	LENS	PMMA	CLEAR

MECHANICAL DRAWING

PRODUCT
C15986_STRADELLA-8-HV-VSM

LEDiL[®]

Tolerances if not otherwise shown
According to DIN ISO 2768-1
Linear measures:
Up to 30mm class M, otherwise class C.
According to DIN ISO 2768-2
Form and position: class L

FIRST ANGLE PROJECTION:

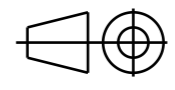

This drawing is the property of LEDiL Oy. It may not be reproduced, copied or communicated without a written agreement with LEDiL Oy.

SCALE	3:2	SIZE	A3	SHEET	1/2
-------	-----	------	----	-------	-----

Notes

- PCB or Heat Sink level
 - Led location see red dot
- Ensure LED fitting, see our web site and/or 3D model for part detail.
See installation details page 2.

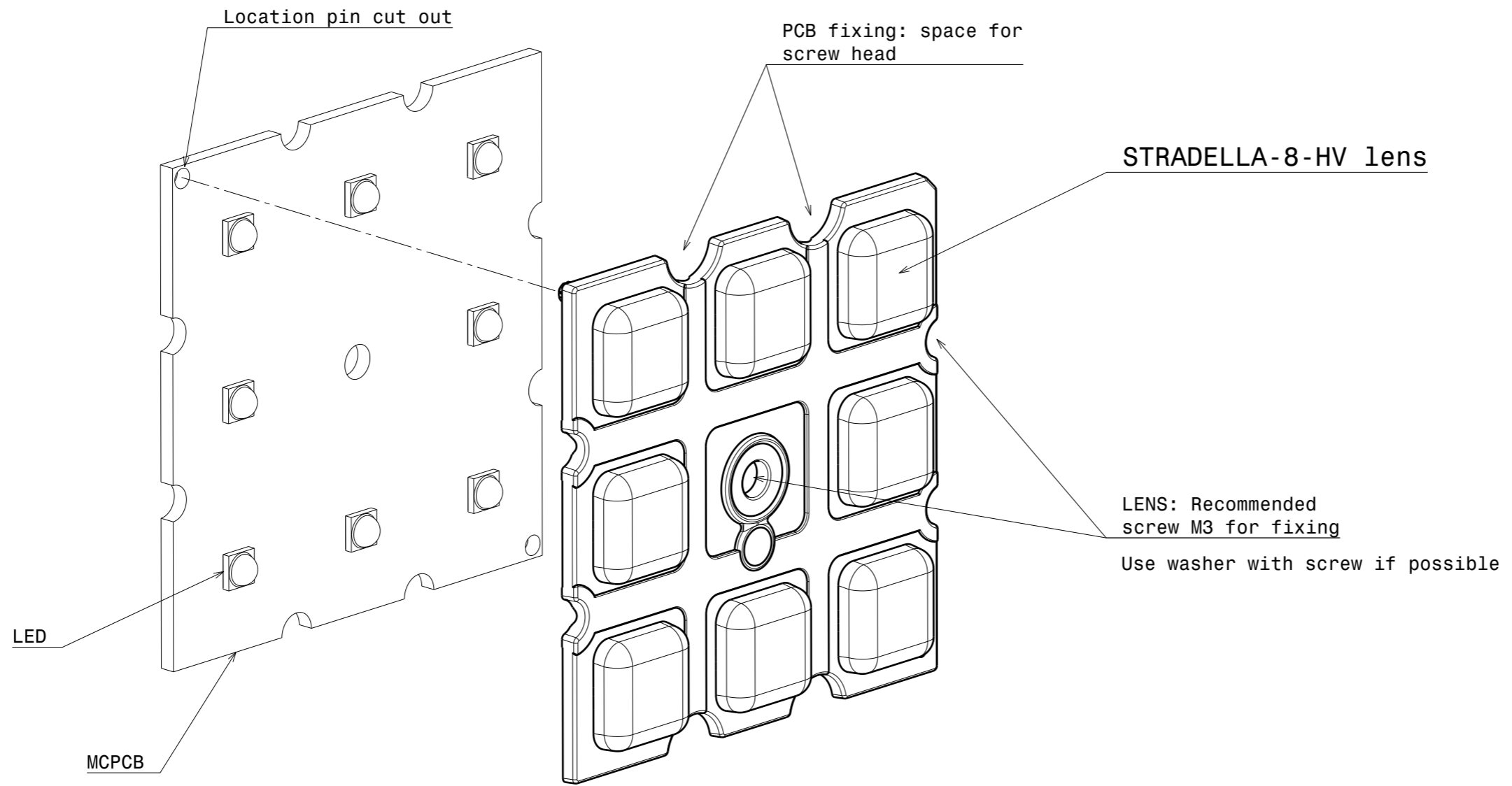

Notes

Please see more details for fastening in LEDiL Installation guide, www.ledil.com

MECHANICAL DRAWING		LEDiL[®]			
PRODUCT STRADELLA-8-HV family					
Tolerances if not otherwise shown According to DIN ISO 2768-1 Linear measures: Up to 30mm class M, otherwise class C. According to DIN ISO 2768-2 Form and position: class L	FIRST ANGLE PROJECTION: 	This drawing is the property of LEDiL Oy. It may not be reproduced, copied or communicated without a written agreement with LEDiL Oy.			
SCALE	2:1	SIZE	A3	SHEET	2/2

Luminaire: Ledil C15986_STRADELLA-8-HV-VSM_(XD16)

Lamps: 1 x Cree_XD16_(XD16AWT-H-2B0-S20-0B-002)_903.058lm@250mA_CCT=5700K_P5.51704=W_I=0.250A

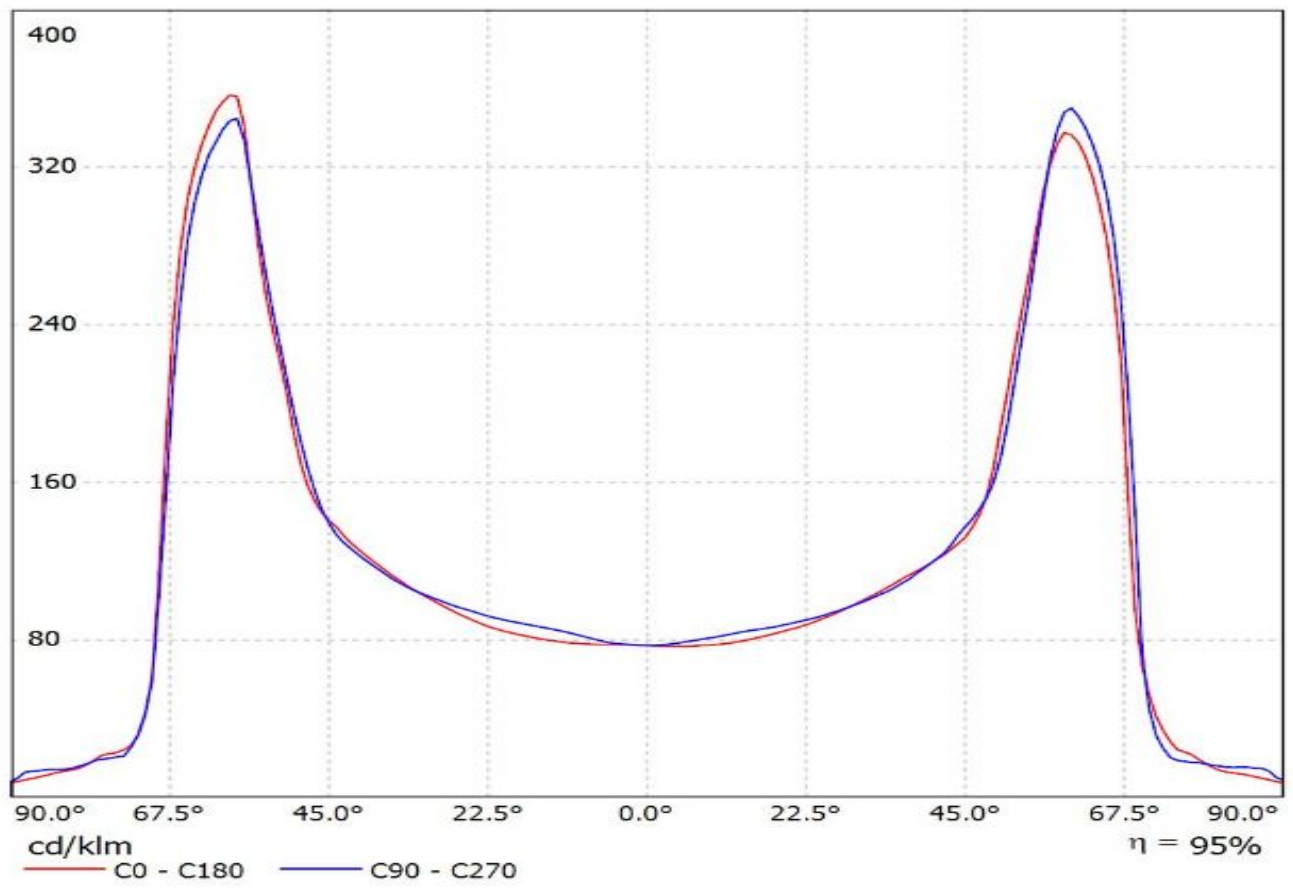

Luminaire: Ledil Oy C15986_STRADELLA-8-HV-VSM_SIMULATED
Lamps: 1 x Cree_XP-G3

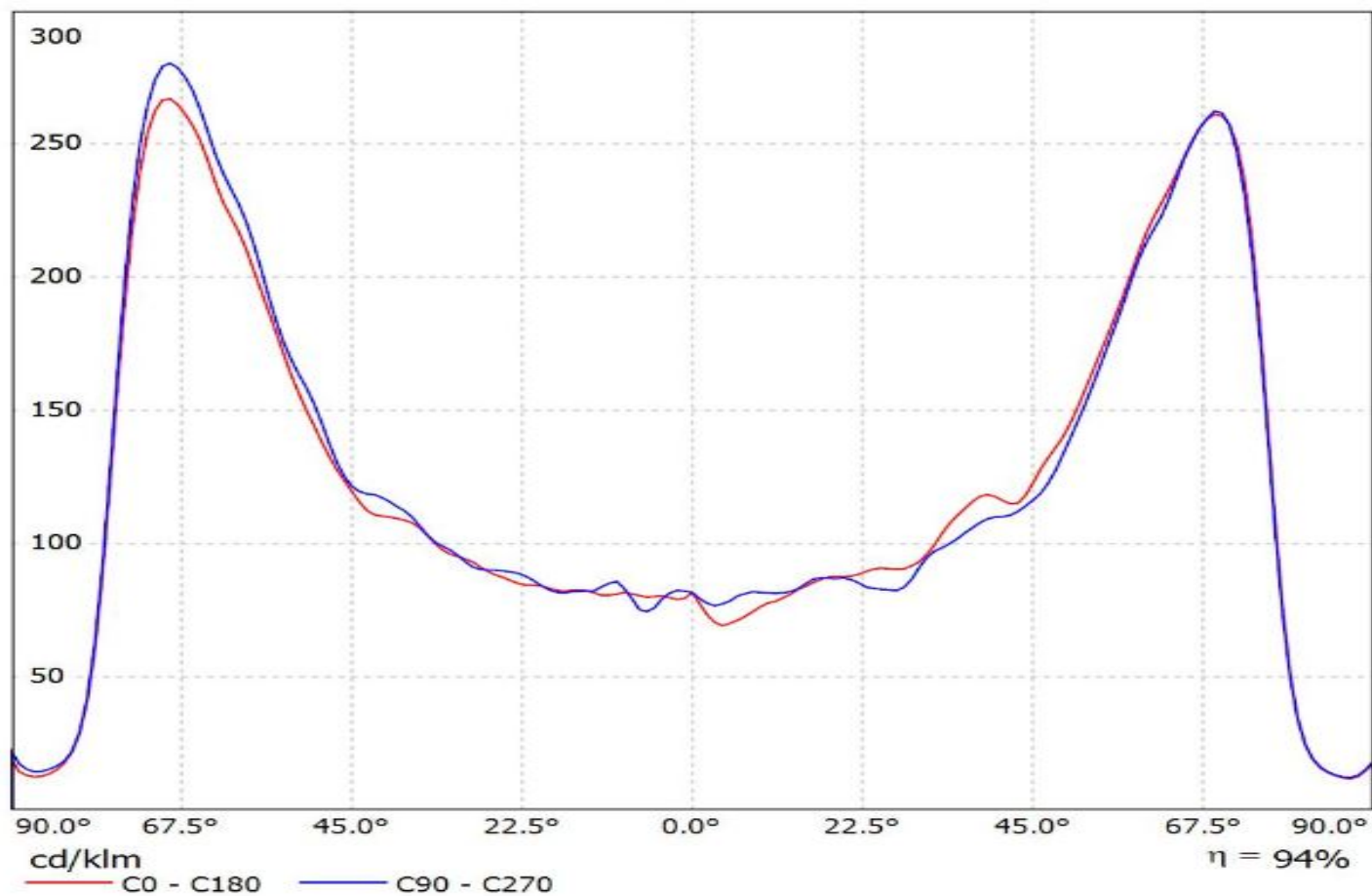

Luminaire: Ledil C15986_STRADELLA-8-HV-VSM_(NVSW219D)

Lamps: 1 x NICHIA_NVSW219D_Stradella-8_(sm403D320R70)_972.863lm@250mA_CCT=4000K_P=5.58452W_U=22.347V

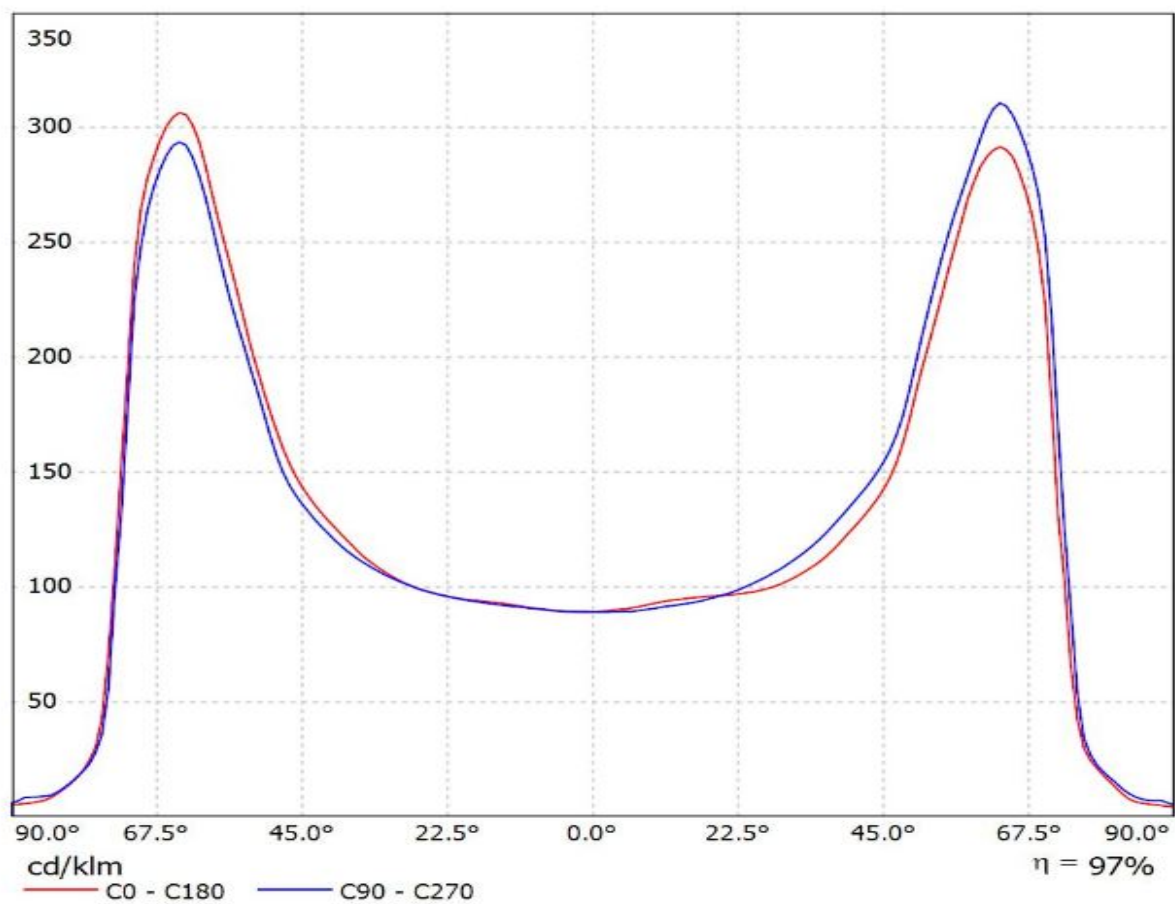

Luminaire: Ledil Oy C15986_STRADELLA-8-HV-VSM_(Oslon_Square_Gen3)_SIMULATED
Lamps: 1 x Osram Oslon Square Gen3 - GW CSSRM2.PM

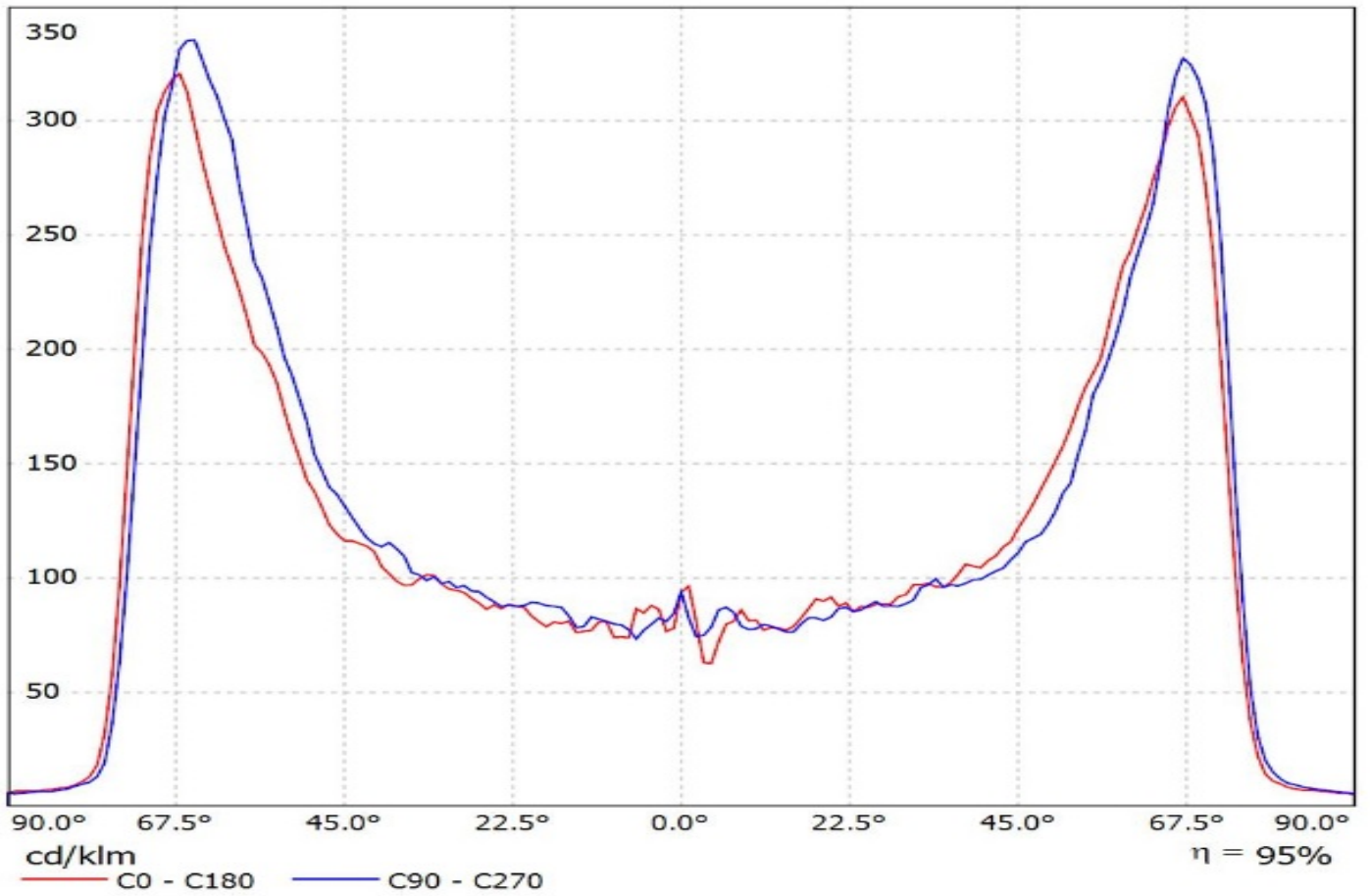

Luminaire: Ledil Oy C15986_STRADELLA-8-HV-VSM_(LH181A)_SIMULATED
Lamps: 1 x Samsung LH181A

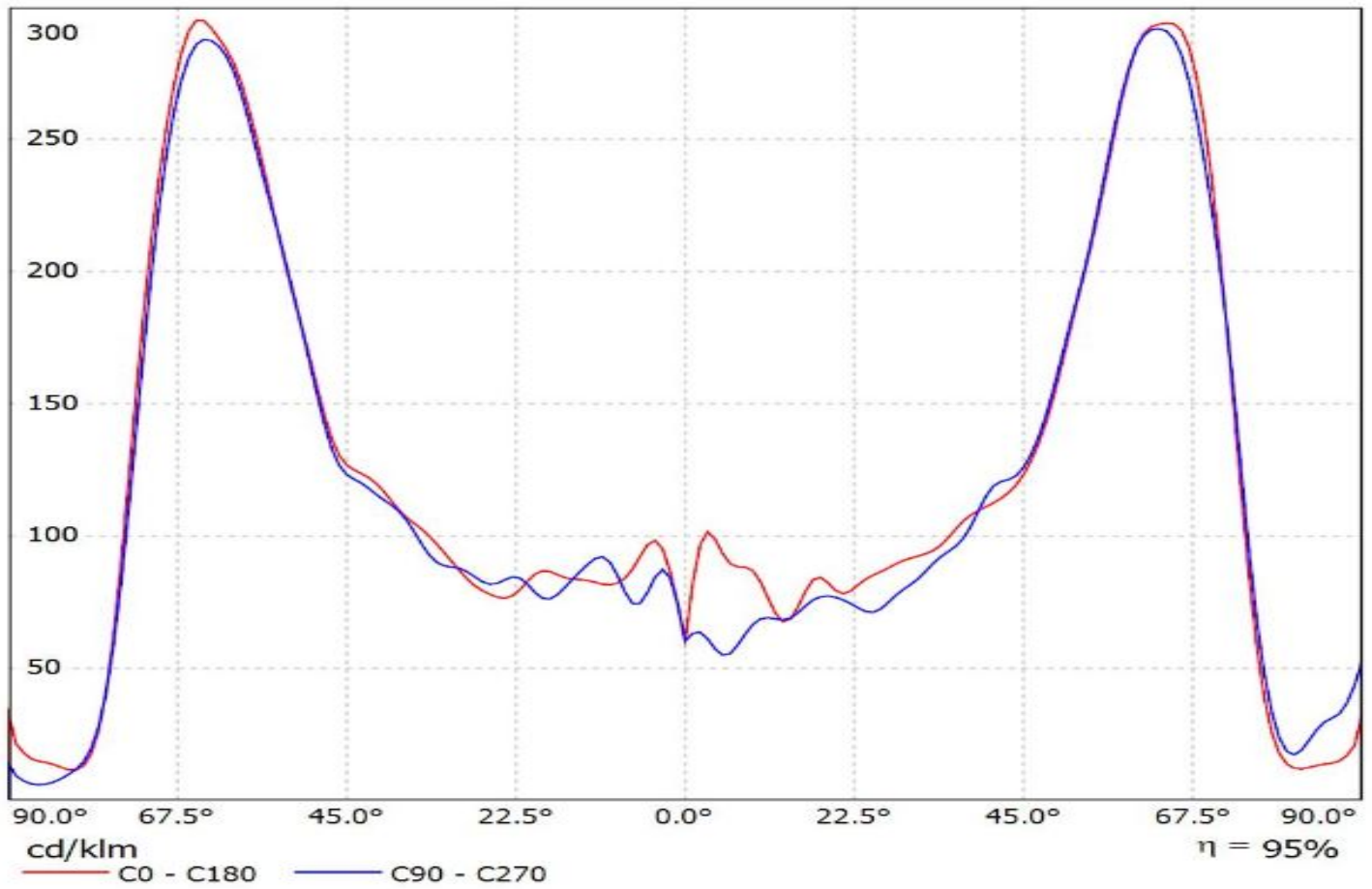

Luminaire: Ledil Oy C15986_STRADELLA-8-HV-VSM_(LH181B)_SIMULATED
Lamps: 1 x Samsung LH181B

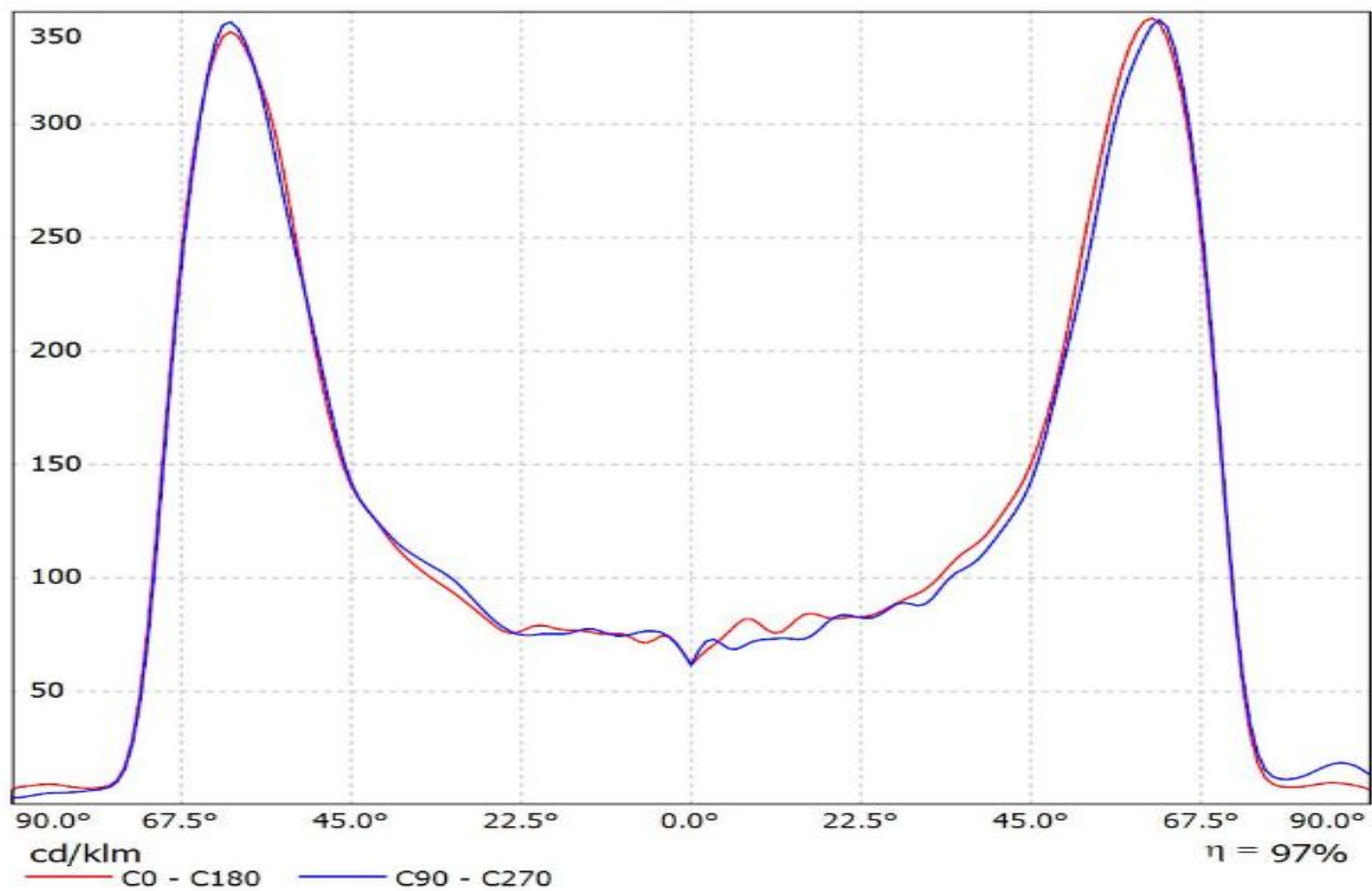

Luminaire: Ledil C15986_STRADELLA-8-HV-VSM_(XD16)

Lamps: 1 x Cree_XD16_(XD16AWT-H-2B0-S20-0B-002)_903.058lm@250mA_CCT=5700K_P5.51704=W_I=0.250A

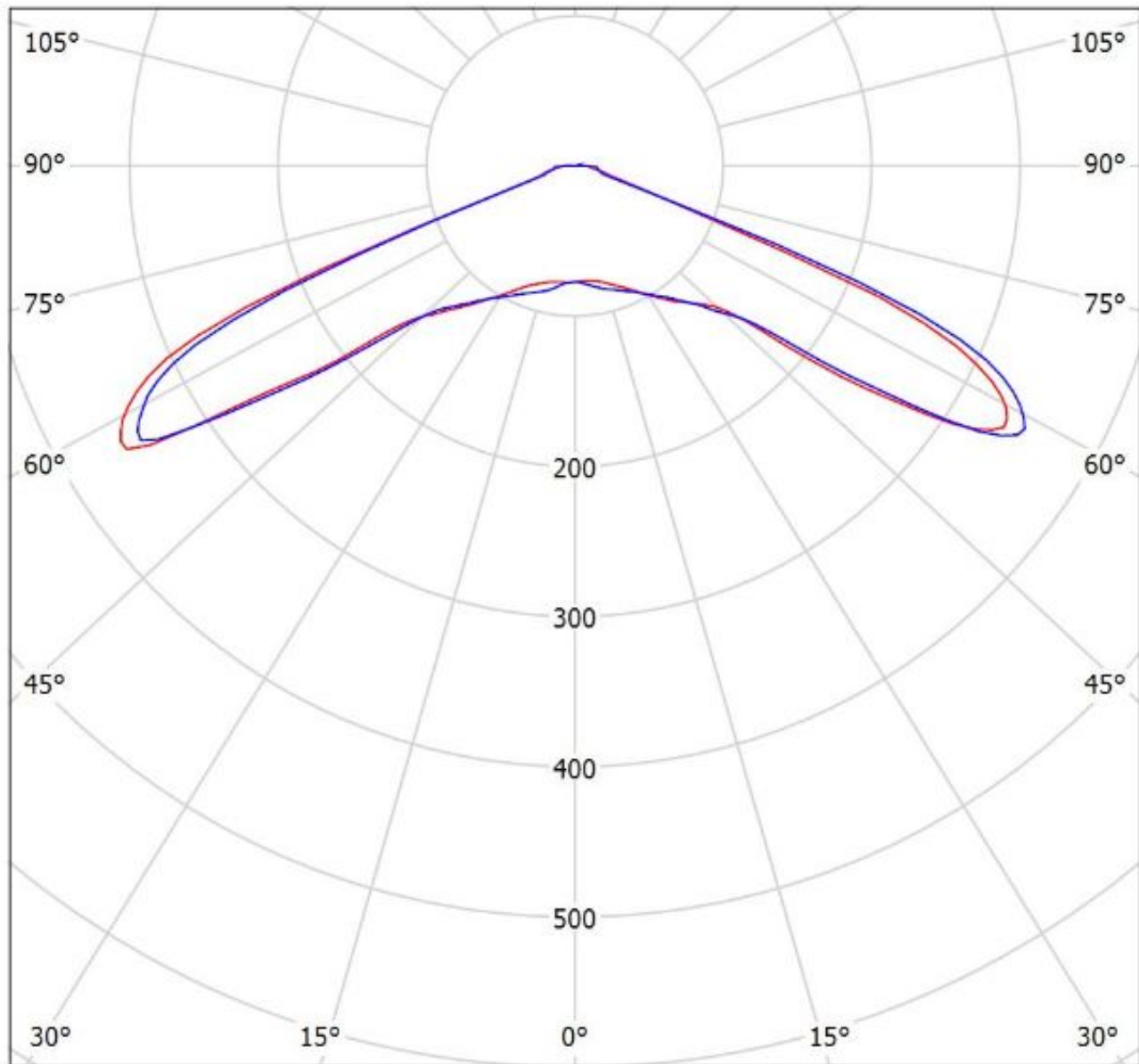

cd/klm

— C0 - C180 — C90 - C270

$\eta = 95\%$

Luminaire: Ledil Oy C15986_STRADELLA-8-HV-VSM_SIMULATED

Lamps: 1 x Cree_XP-G3

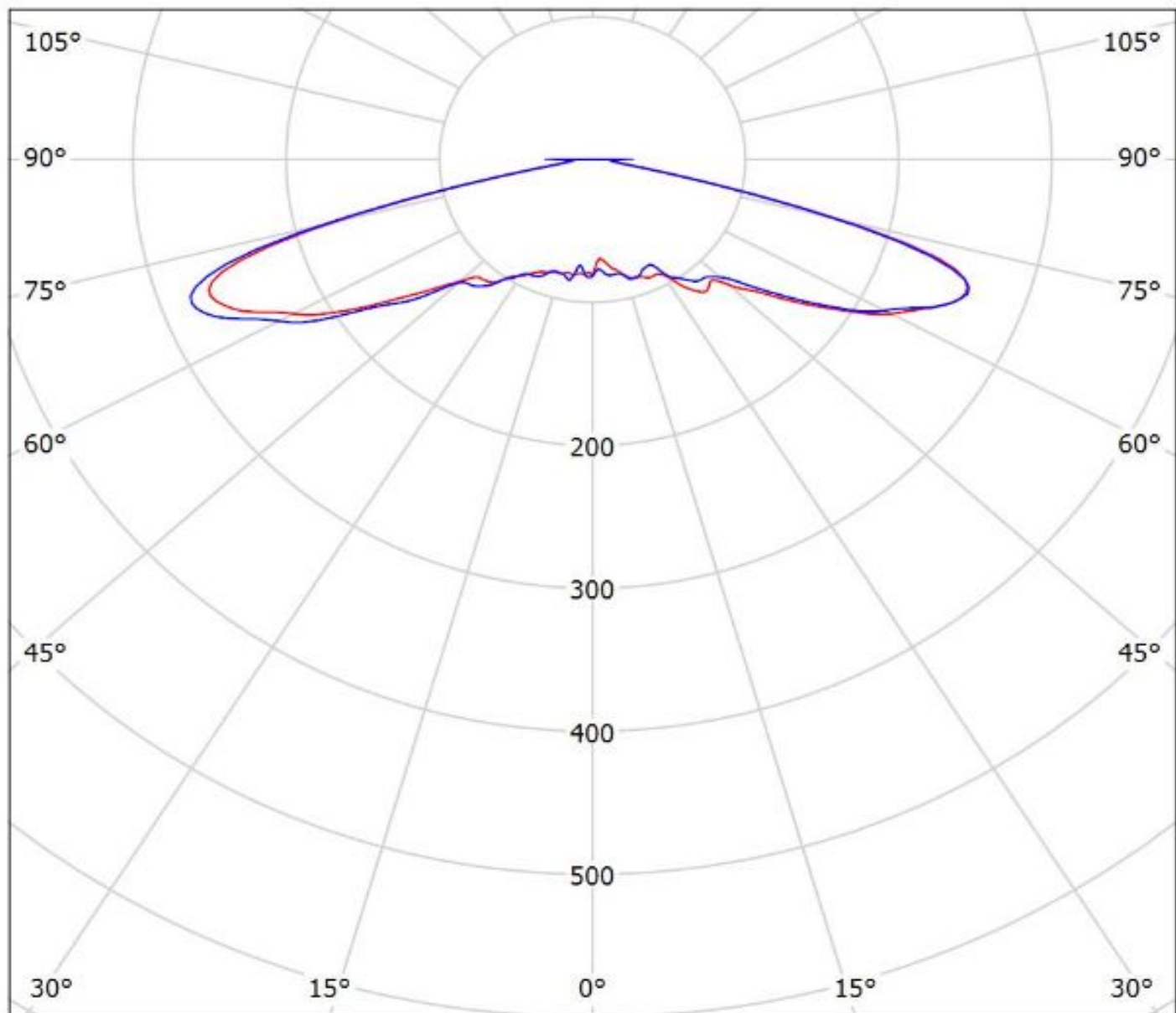

cd/klm

— C0 - C180 — C90 - C270

$\eta = 94\%$

Luminaire: Ledil C15986_STRADELLA-8-HV-VSM_(NVSW219D)

Lamps: 1 x NICHIA_NVSW219D_Stradella-8_(sm403D320R70)_972.863lm@250mA_CCT=4000K_P=5.58452W_U=22.347V

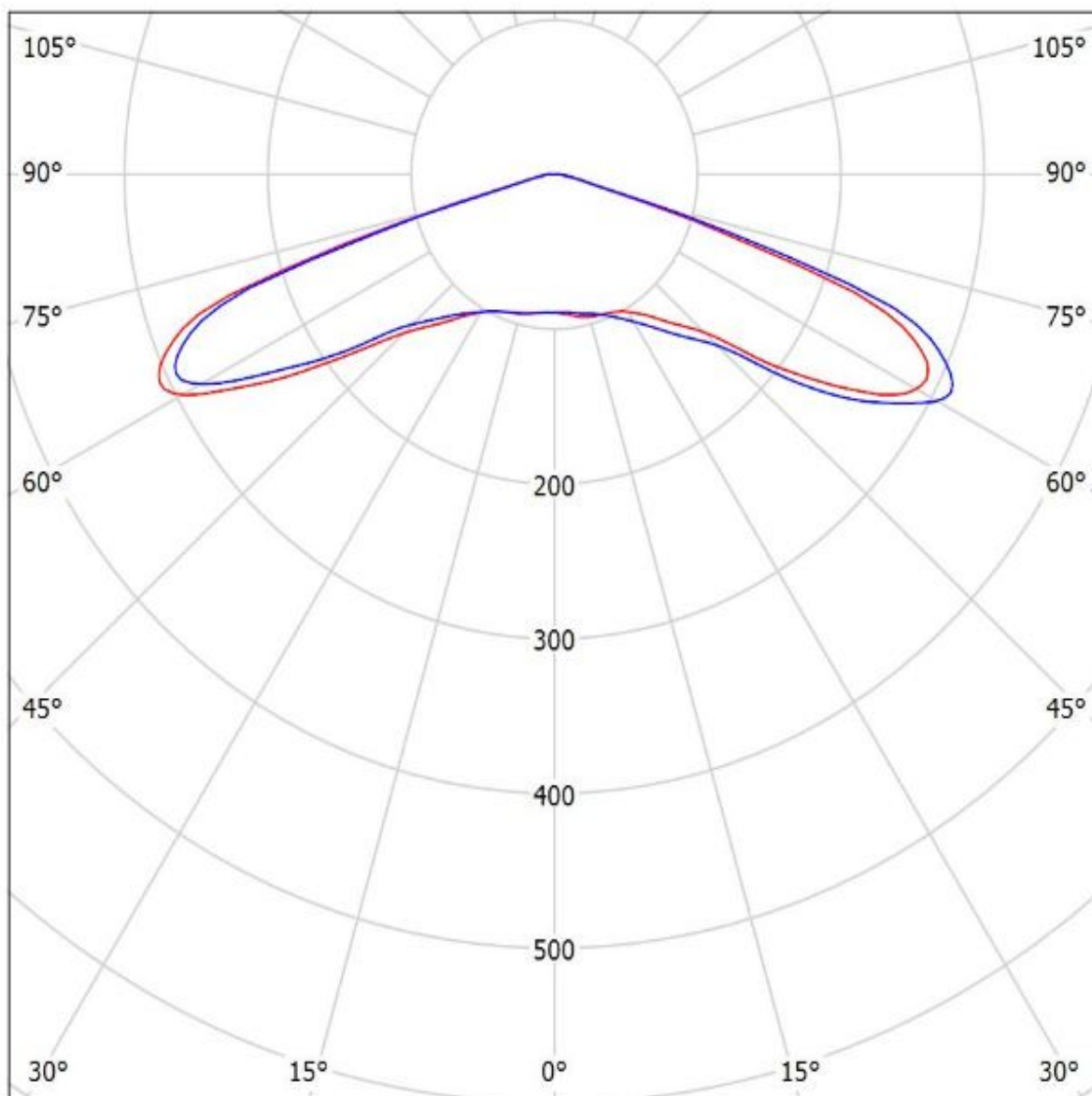

cd/klm

— C0 - C180 — C90 - C270

$\eta = 97\%$

Luminaire: Ledil Oy C15986_STRADELLA-8-HV-VSM_(Oslon_Square_Gen3)_SIMULATED
Lamps: 1 x Osram Oslon Square Gen3 - GW CSSRM2.PM

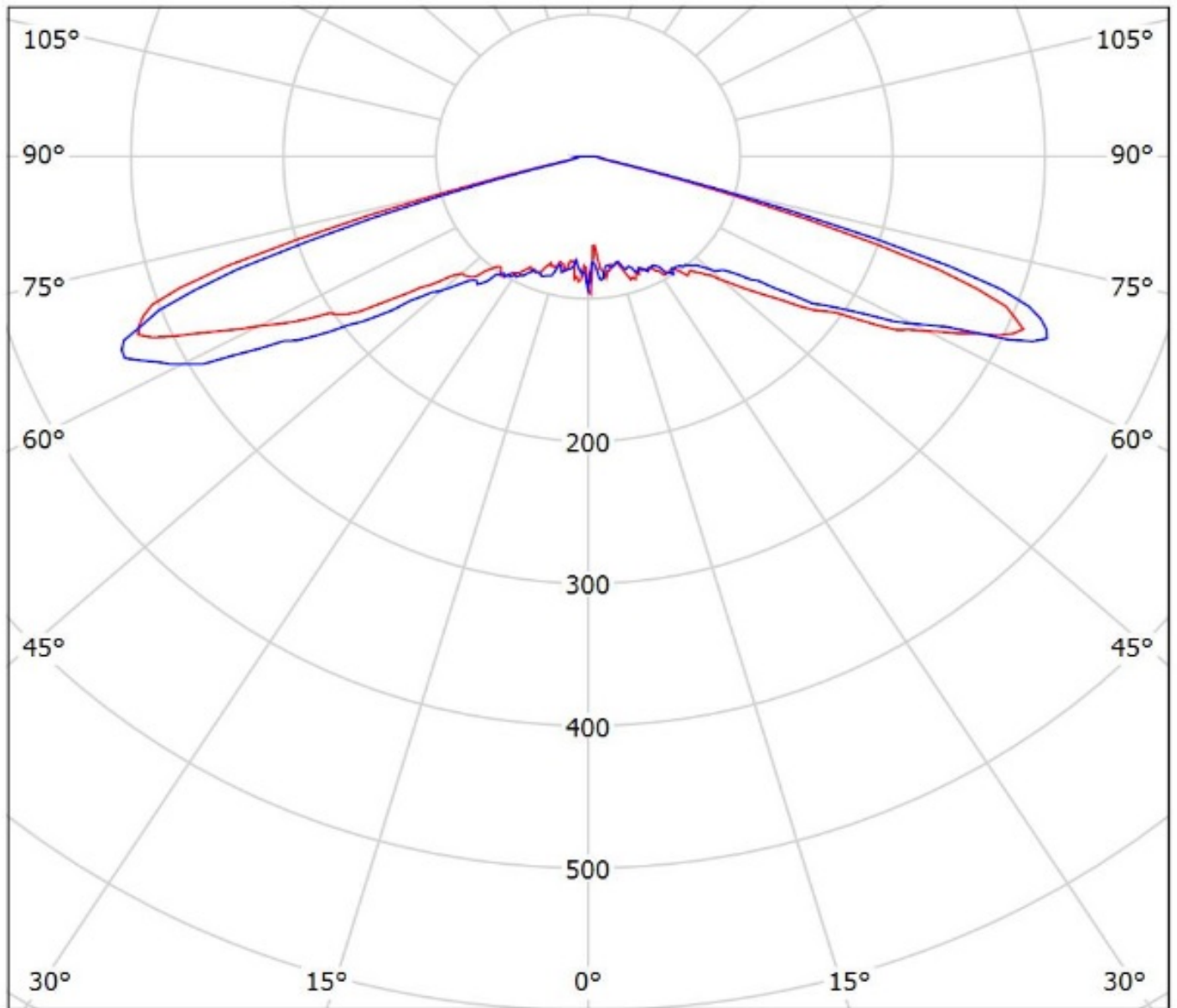

cd/klm
— C0 - C180 — C90 - C270

$\eta = 95\%$

Luminaire: Ledil Oy C15986_STRADELLA-8-HV-VSM_(LH181A)_SIMULATED
Lamps: 1 x Samsung LH181A

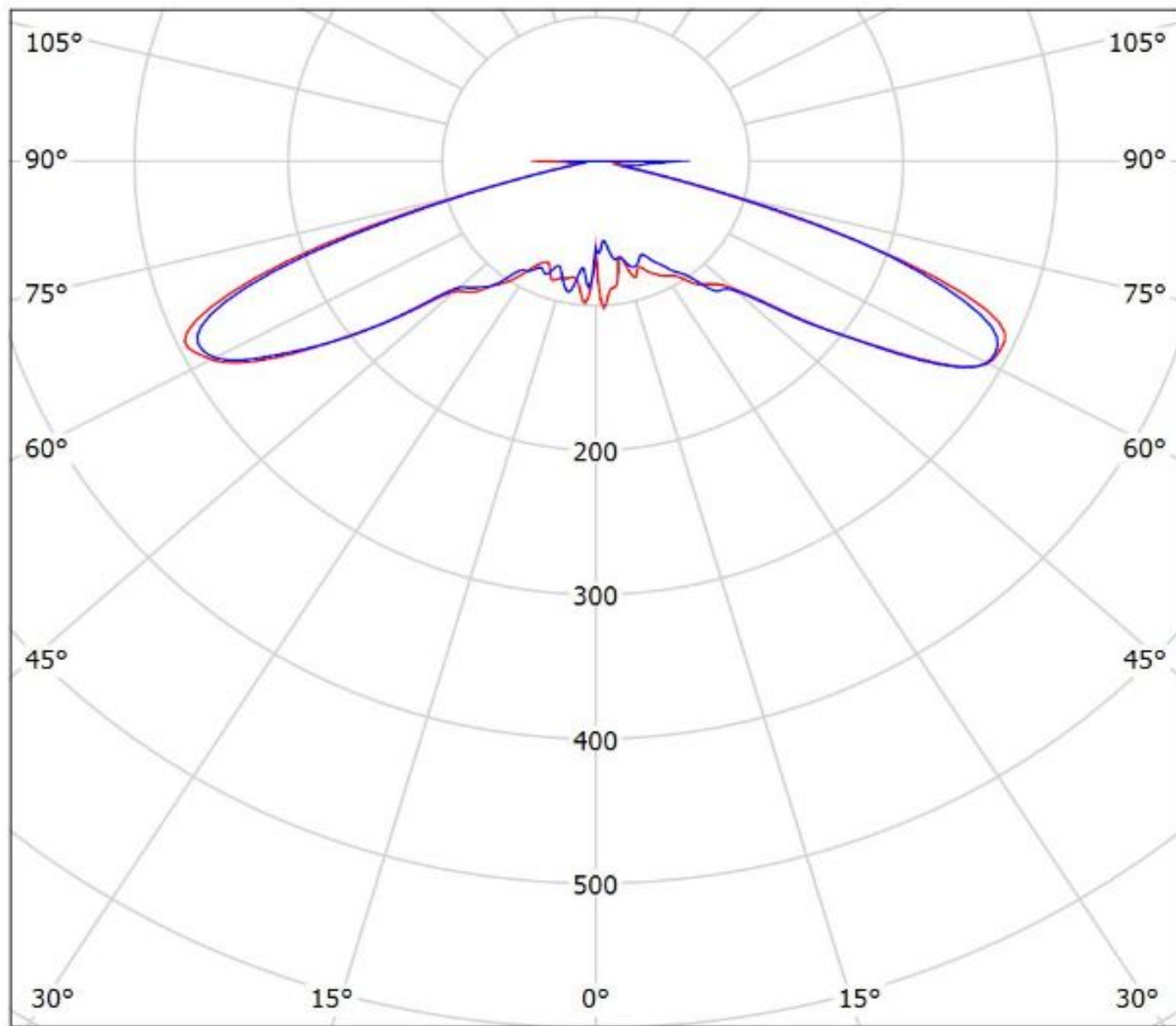

cd/klm
— C0 - C180 — C90 - C270

$\eta = 95\%$

Luminaire: Ledil Oy C15986_STRADELLA-8-HV-VSM_(LH181B)_SIMULATED
Lamps: 1 x Samsung LH181B

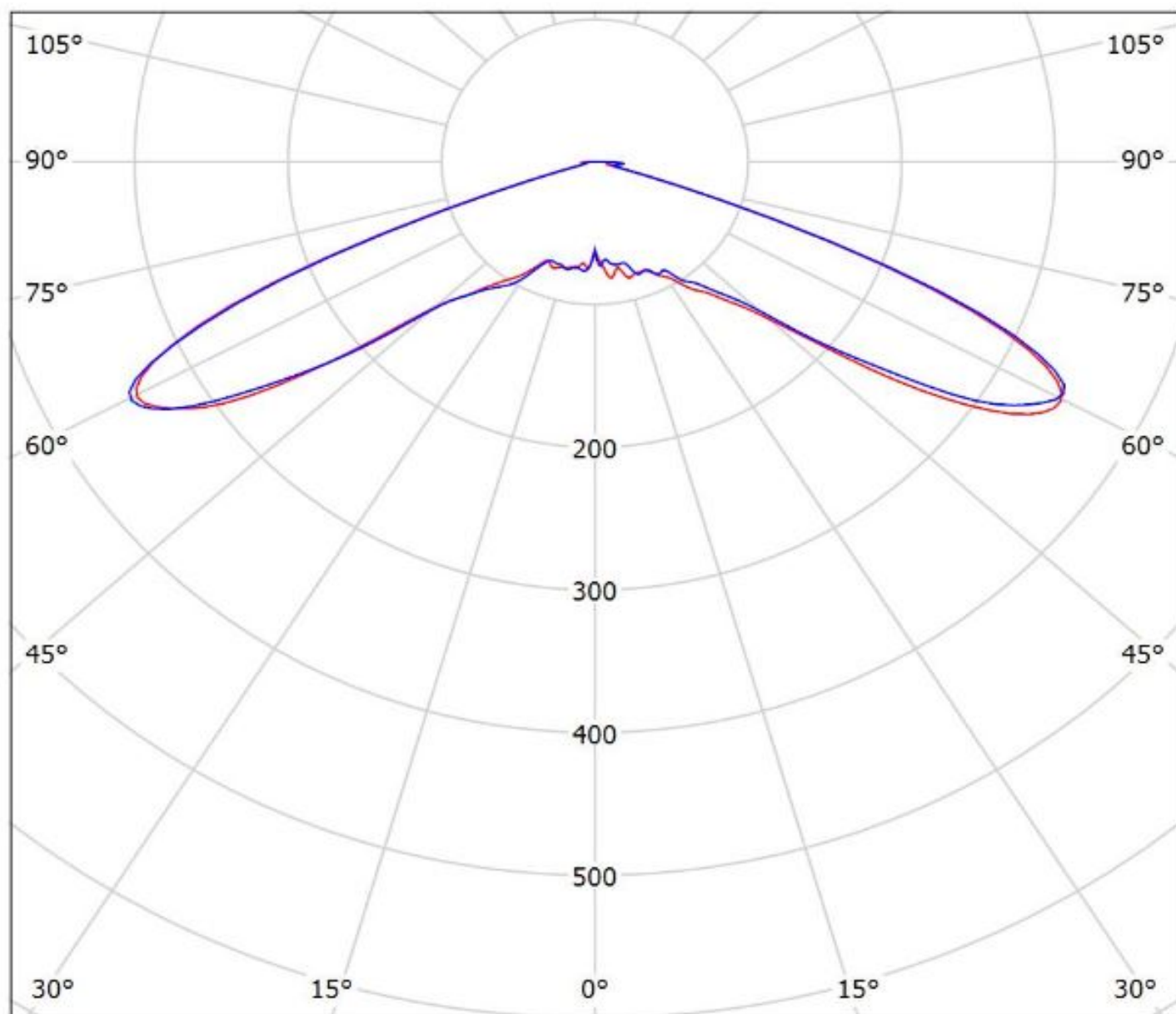

cd/klm

— C0 - C180 — C90 - C270

$\eta = 97\%$

NOTE: The typical divergence will be changed by different color, chip size and chip position tolerance. The typical total divergence is the full angle measured where the luminous intensity is half of the peak value.