

## DETAILS

<b>Product Number</b>	C16118_STRADELLA-8-HV-HB-O
<b>Family</b>	Stradella
<b>Type</b>	Lens array
<b>Color</b>	clear
<b>Diameter</b>	49,5+49,5 mm
<b>Height</b>	9,1 mm
<b>Style</b>	rectang
<b>Optic Material</b>	PMMA
<b>Holder Material</b>	
<b>Fastening</b>	pin, screw
<b>Status</b>	production ready
<b>ROHS Compliant</b>	Yes
<b>Date Updated</b>	29/09/2017



## OPTICAL PROPERTIES

LED	Viewing	Light	Effi-		
	Angle	Beam	ciency	cd/lm	Connector
XT-E	sim: AsymmetriOval		sim: 89 %	sim: 1.390	-
XP-G2	sim: AsymmetriOval		sim: 92 %	sim: 1.544	-
XD16	66+20 deg	Oval	94 %	0.900	-
LUXEON 3030 2D	sim: 61+17	Oval	sim: 93 %	sim: 1.400	-
LH181A	sim: AsymmetriOval		sim: 92 %	sim: 1.080	-
LH181B	sim: AsymmetriOval		sim: 94 %	sim: 1.280	-

H G F E D C B A

4

3

2

1

4

3

2

1

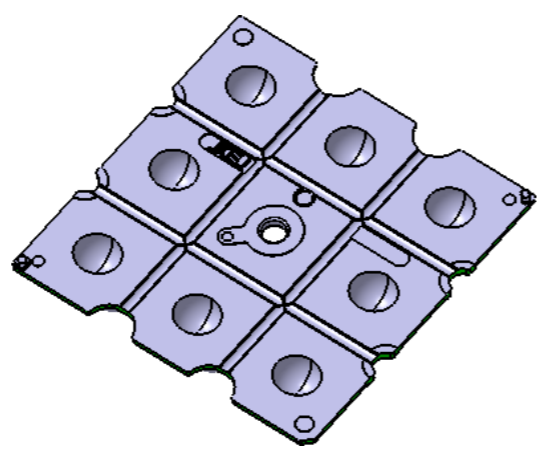
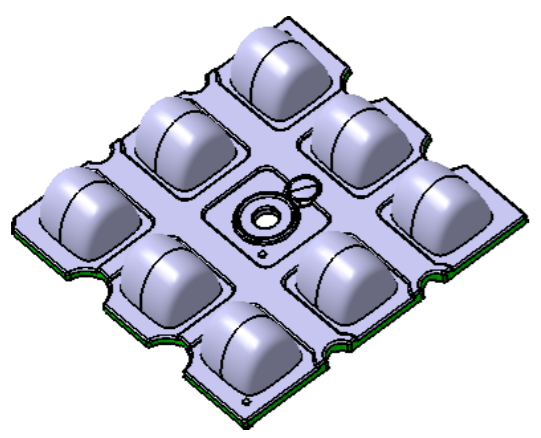
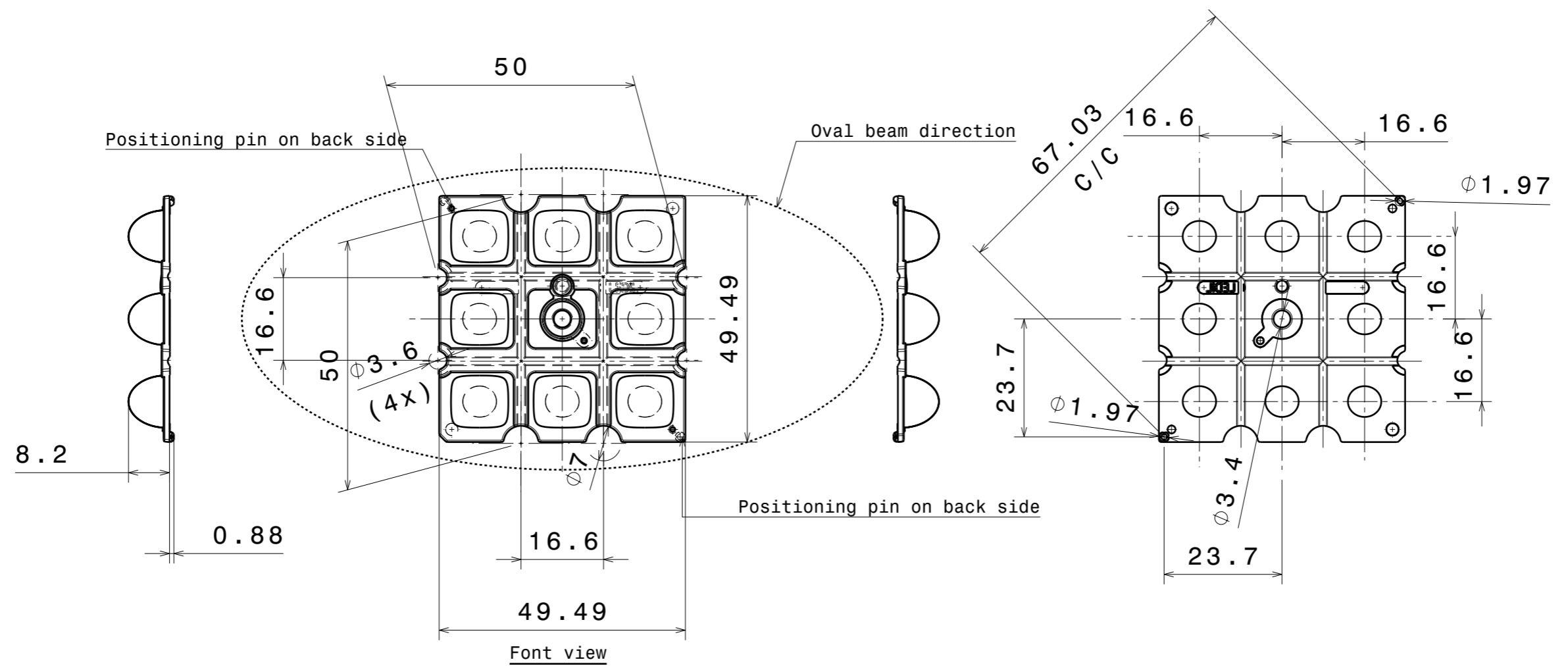

INDEX	PART NO	DESCRIPTION	MATERIAL	COLOUR
1	C16118	STRADELLA-8-HV-HB-0	PMMA	Clear

Tolerances if not otherwise shown  
According to DIN ISO 2768-1  
Linear measures:  
Up to 30mm class M, otherwise class C.  
According to DIN ISO 2768-2  
Form and position: class L

**LEDiL** LediL Oy  
Salorankatu 10  
FIN 24240 SALO  
Finland

THIRD ANGLE PROJECTION:

DRAWING TITLE  
C16118\_STRADELLA-8-HV-HB-0 Datasheet

This drawing is the property of LEDiL Oy. It may not be reproduced, copied or communicated without a written agreement with LEDiL Oy.

SIZE	PART NUMBER
A3	C16118

SCALE	1:1	WEIGHT	6,64 g	SHEET	1/1
-------	-----	--------	--------	-------	-----

H G B A

Luminaire: Ledil C16118\_STRADELLA-8-HV-HB-O\_(XD16)

Lamps: 1 x Cree\_XD16\_(XD16AWT-H-2B0-S20-0B-002)\_903.058lm@250mA\_CCT=5700K\_P5.51704=W\_I=0.250A

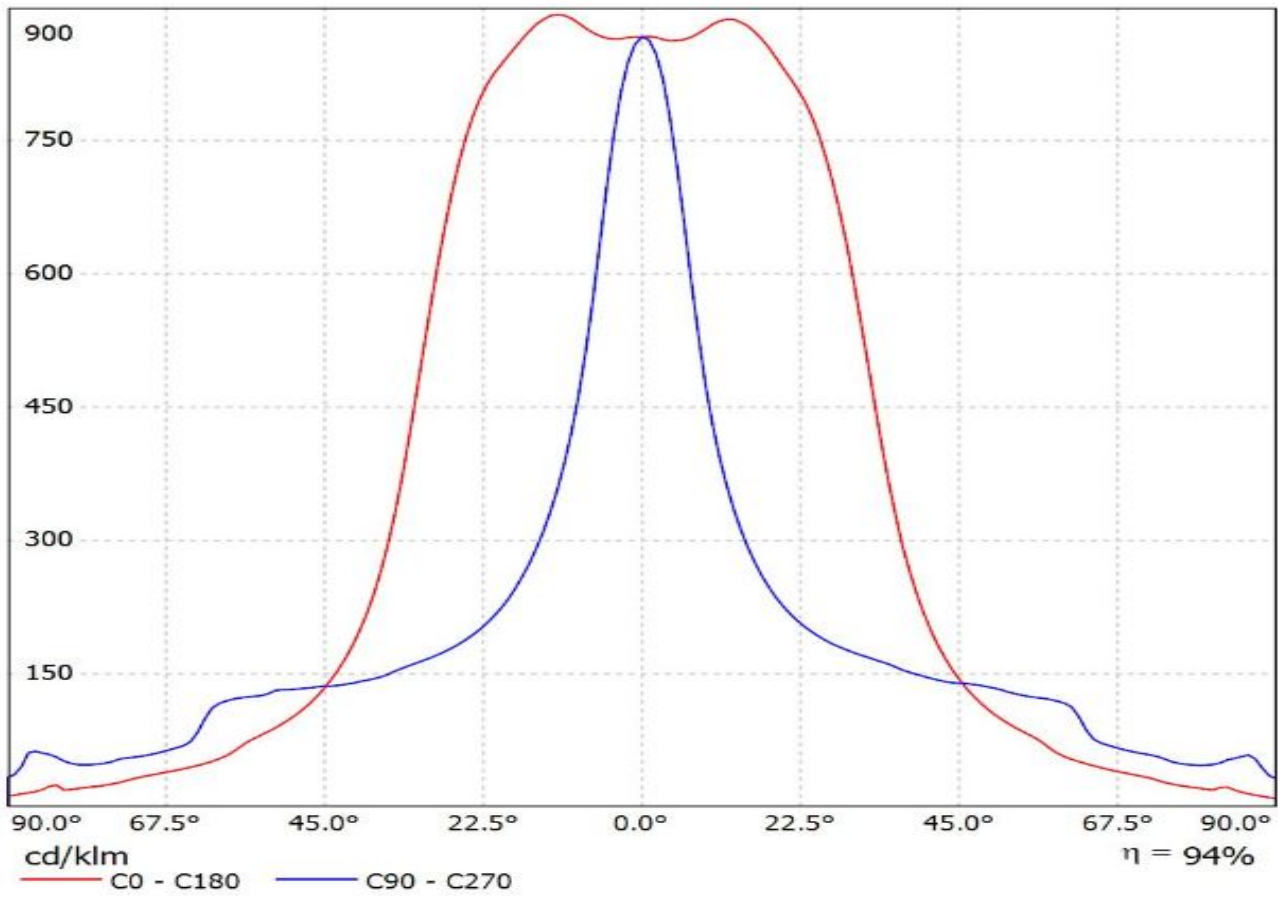

Luminaire: Ledil Oy C16118\_STRADELLA-8-HV-HB-O\_SIMULATED  
Lamps: 1 x LUMILEDS\_LUXEON\_3030\_2D

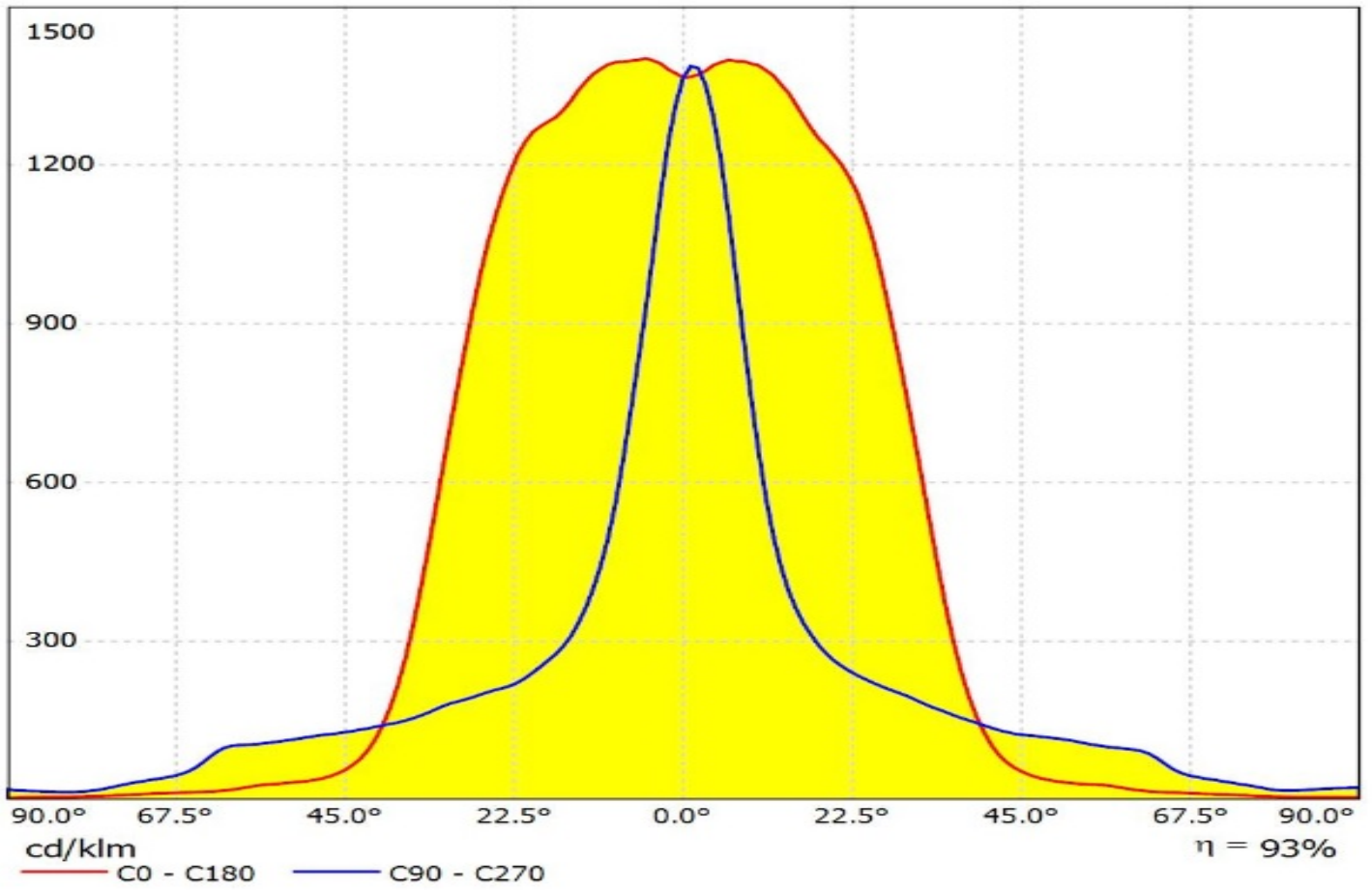

Luminaire: Ledil Oy C16118\_STRADELLA-8-HV-HB-O\_(LH181B)\_SIMULATED  
Lamps: 1 x Samsung LH181B

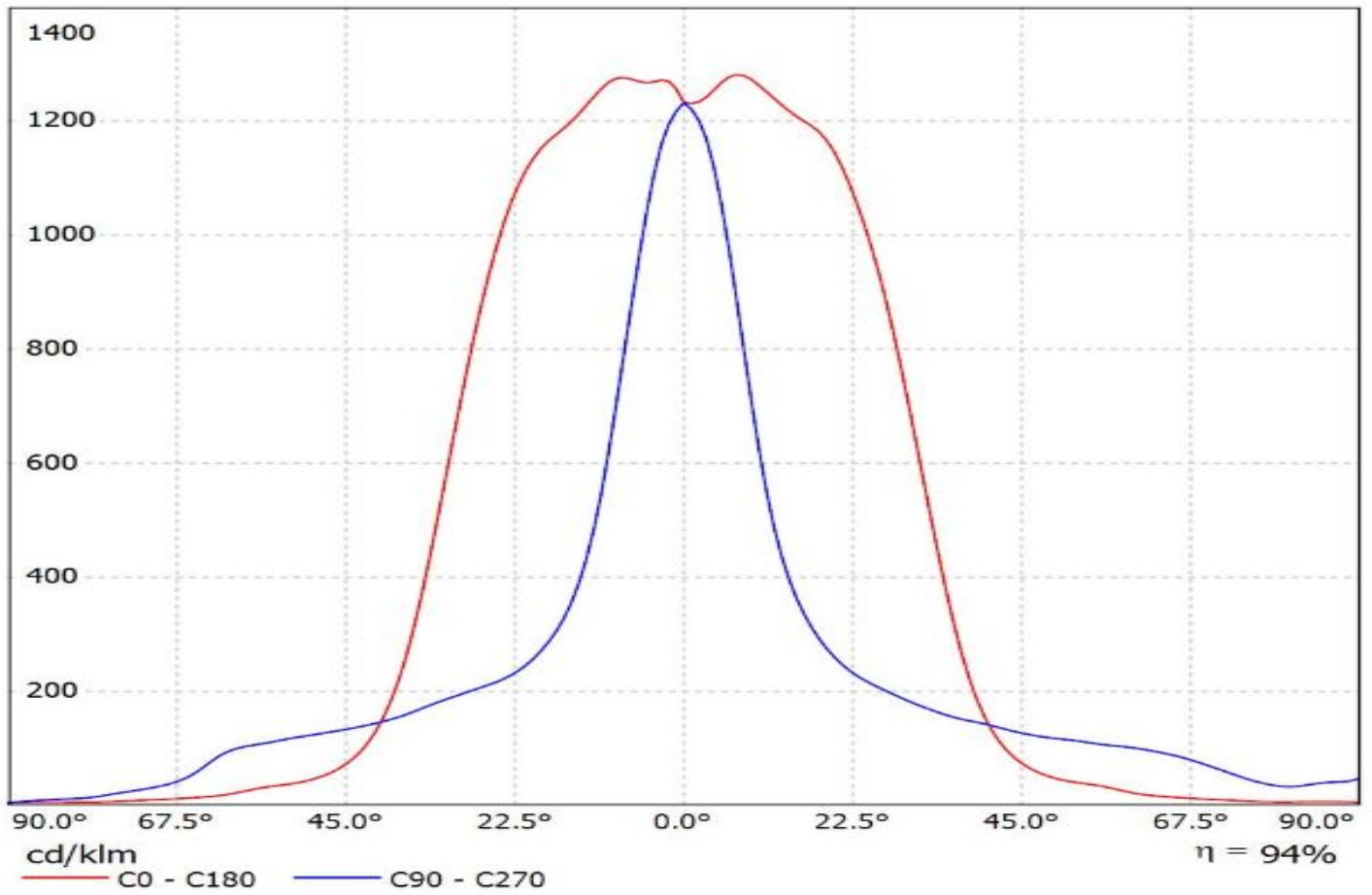

Luminaire: Ledil C16118\_STRADELLA-8-HV-HB-O\_(XD16)

Lamps: 1 x Cree\_XD16\_(XD16AWT-H-2B0-S20-0B-002)\_903.058lm@250mA\_CCT=5700K\_P5.51704=W\_I=0.250A

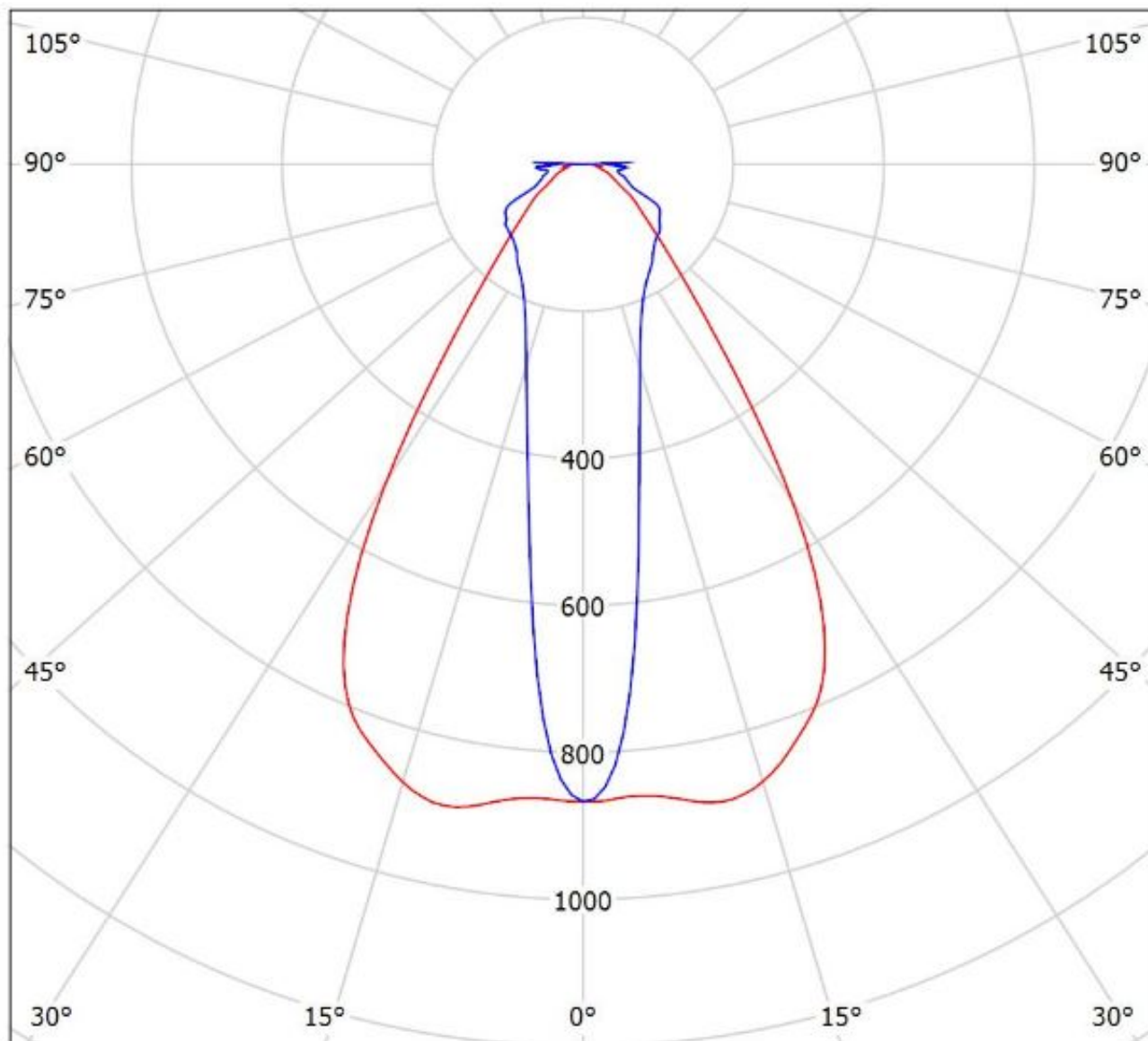

cd/klm

— C0 - C180 — C90 - C270

$\eta = 94\%$

Luminaire: Ledil Oy C16118\_STRADELLA-8-HV-HB-O\_SIMULATED  
Lamps: 1 x LUMILEDS\_LUXEON\_3030\_2D

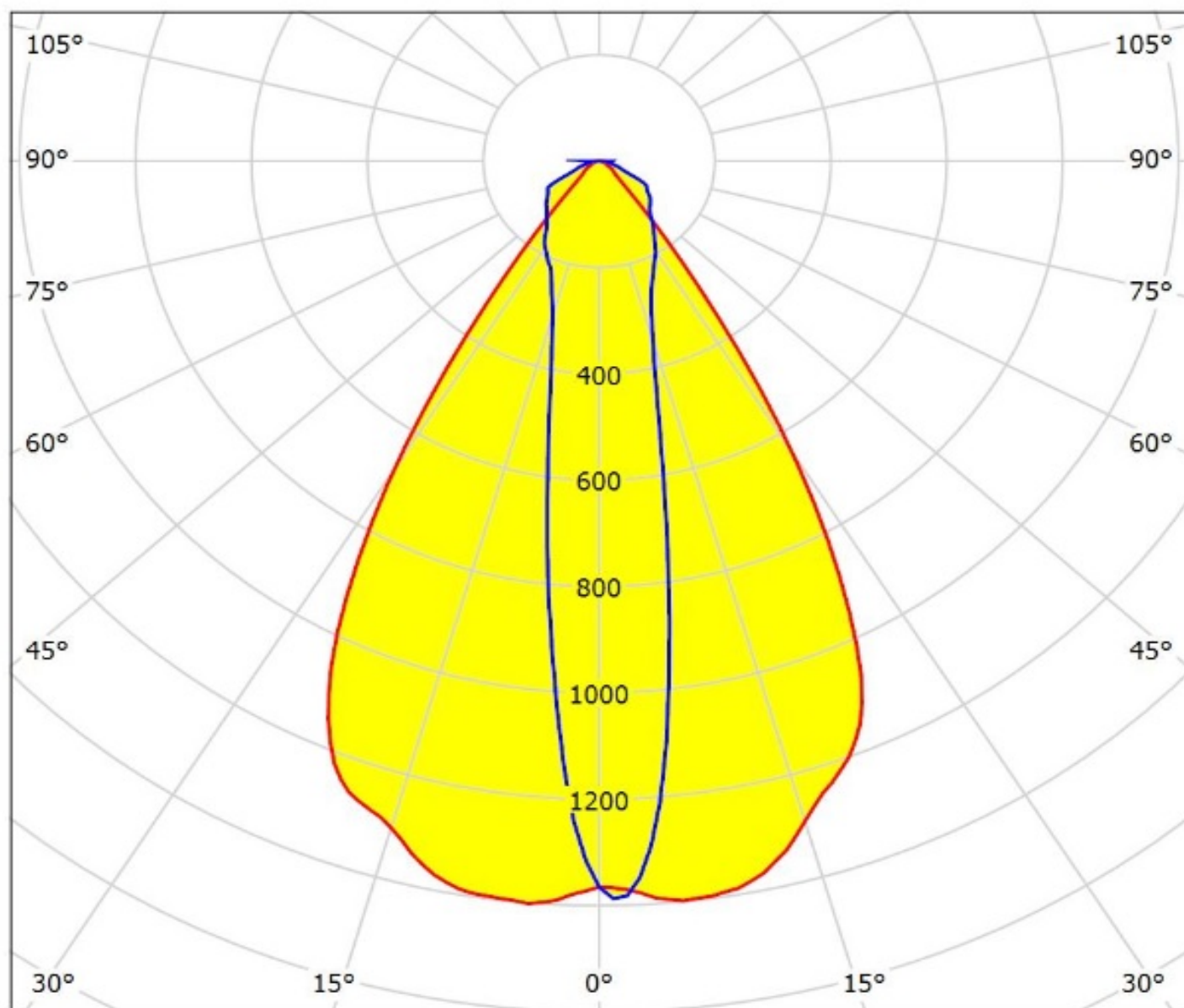

cd/klm

— C0 - C180 — C90 - C270

$\eta = 93\%$

Luminaire: Ledil Oy C16118\_STRADELLA-8-HV-HB-O\_(LH181A)\_SIMULATED  
Lamps: 1 x Samsung LH181A

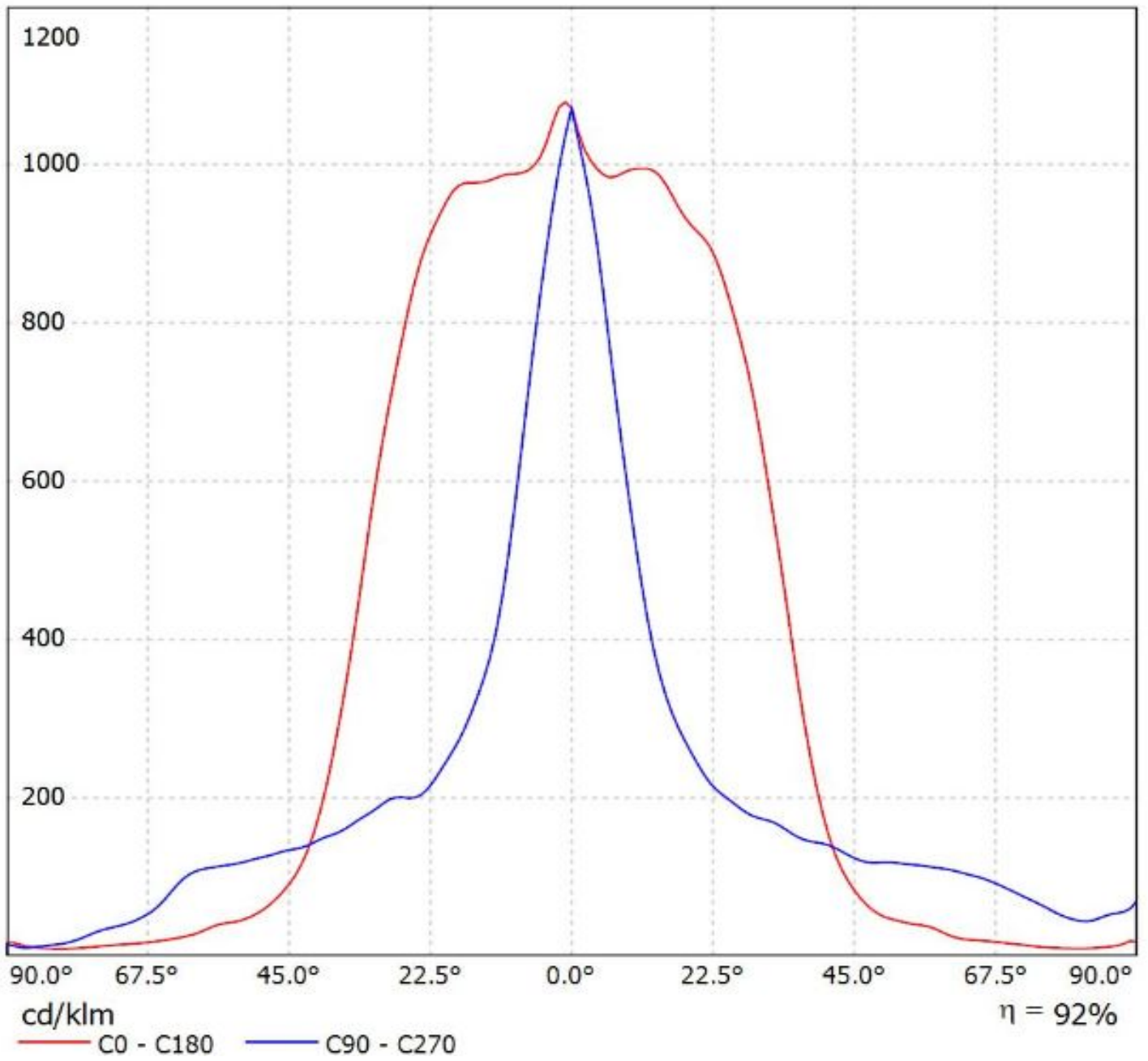

Luminaire: Ledil Oy C16118\_STRADELLA-8-HV-HB-O\_(LH181B)\_SIMULATED  
Lamps: 1 x Samsung LH181B

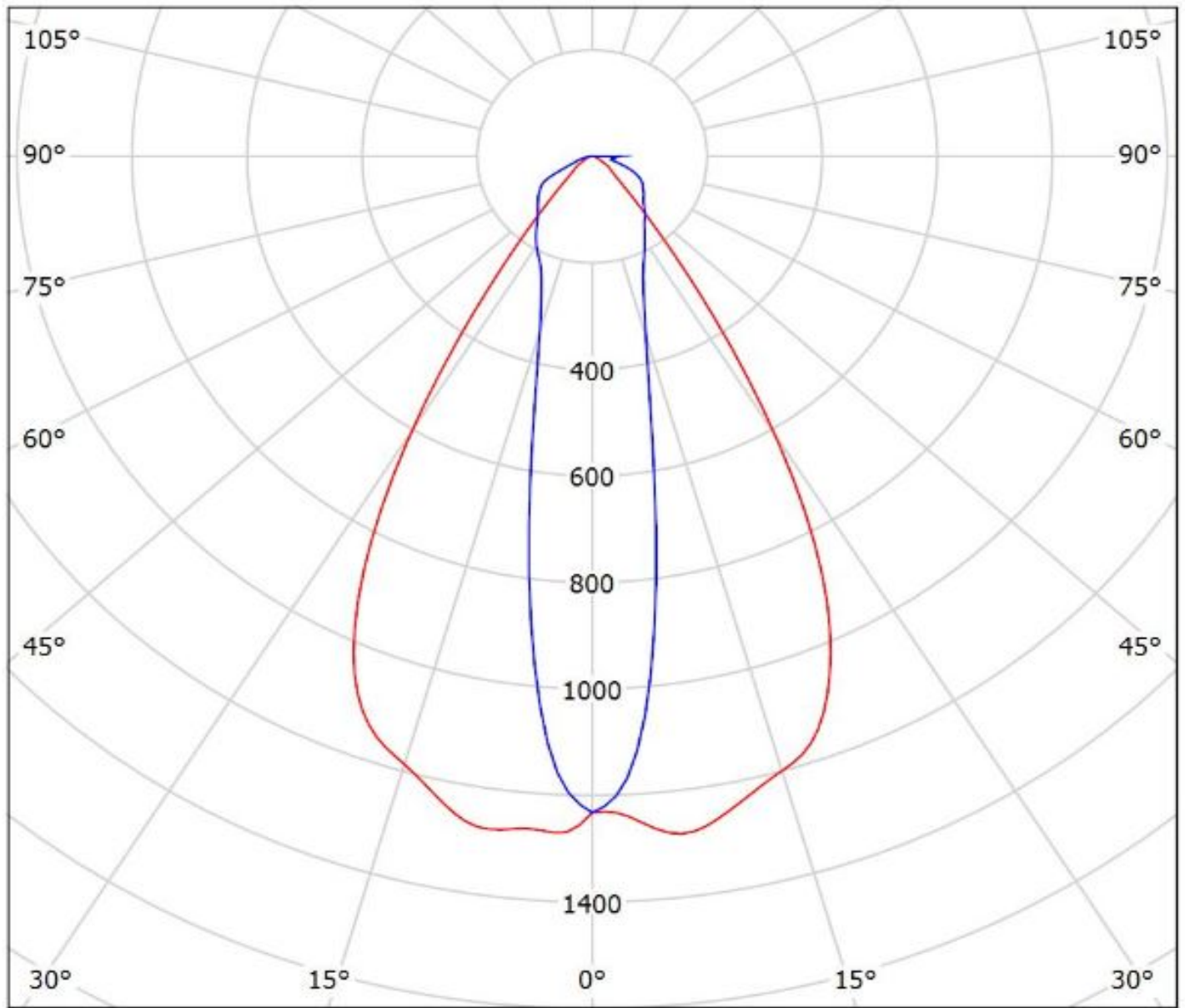

cd/klm

— C0 - C180 — C90 - C270

$\eta = 94\%$

**NOTE: The typical divergence will be changed by different color, chip size and chip position tolerance. The typical total divergence is the full angle measured where the luminous intensity is half of the peak value.**