

## DETAILS

|                        |                          |
|------------------------|--------------------------|
| <b>Product Number</b>  | C15982_STRADELLA-8-HV-T3 |
| <b>Family</b>          | Stradella                |
| <b>Type</b>            | Lens array               |
| <b>Color</b>           | clear                    |
| <b>Diameter</b>        | 49,5+49,5 mm             |
| <b>Height</b>          | 5,7 mm                   |
| <b>Style</b>           | rectang                  |
| <b>Optic Material</b>  | PMMA                     |
| <b>Holder Material</b> |                          |
| <b>Fastening</b>       | pin, screw               |
| <b>Status</b>          | production ready         |
| <b>ROHS Compliant</b>  | Yes                      |
| <b>Date Updated</b>    | 9/06/2017                |



## OPTICAL PROPERTIES

| LED               | Viewing Angle   | Light Beam | Efficiency | cd/lm      | Connector                                       |
|-------------------|-----------------|------------|------------|------------|---|
| XT-E              | Asymmetric deg  | Asymmetric | 96 %       | 0.620      | -   |
| XP-G3             | sim: Asymmetric | Asymmetric | sim: 92 %  | sim: 0.500 | -   |
| XP-G2             | sim: Asymmetric | Asymmetric | sim: 91 %  | sim: 0.600 | -   |
| XD16              | Asymmetric deg  | Asymmetric | 94 %       | 0.800      | -   |
| LUXEON 3030 2D    | sim: Asymmetric | Asymmetric | sim: 94 %  | sim: 0.760 | -   |
| LUXEON 3535 2D    | sim: Asymmetric | Asymmetric | sim: 94 %  | sim: 0.650 | -   |
| LUXEON TX         | Asymmetric deg  | Asymmetric | 94 %       | 0.680      | -   |
| NVSxx19B/NVSxx19C | sim: Asymmetric | Asymmetric | sim: 94 %  | sim: 0.580 | -   |
| NF2x757D          | sim: Asymmetric | Asymmetric | sim: 95 %  | sim: 0.800 | -   |
| NVSxx19B/NVSxx19C | sim: Asymmetric | Asymmetric | sim: 84 %  | sim: 0.450 | Undefined Manufacturer: Protective Plate, Glass |
| Oslon Square EC   | sim: Asymmetric | Asymmetric | sim: 93 %  | sim: 0.700 | -   |
| Duris S5 (2 chip) | sim: Asymmetric | Asymmetric | sim: 95 %  | sim: 0.740 | -   |
| LH181A            | sim: Asymmetric | Asymmetric | sim: 94 %  | sim: 0.630 | -   |
| LH181B            | sim: Asymmetric | Asymmetric | sim: 94 %  | sim: 0.660 | -   |

H G F E D C B A

4

4

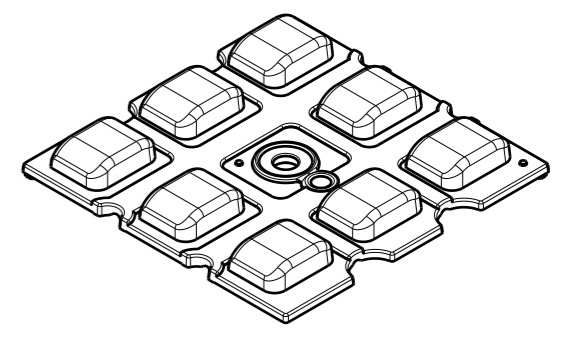

Light direction

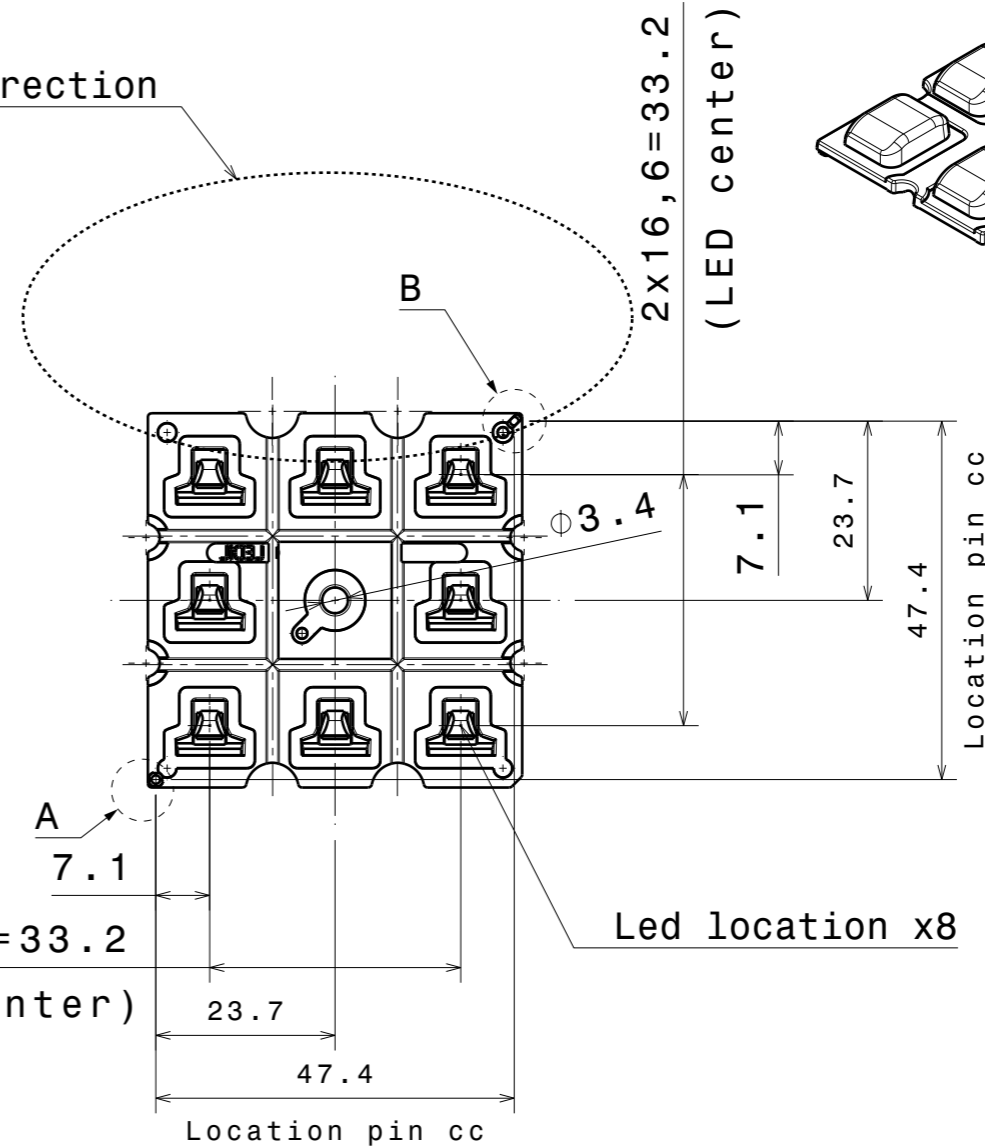
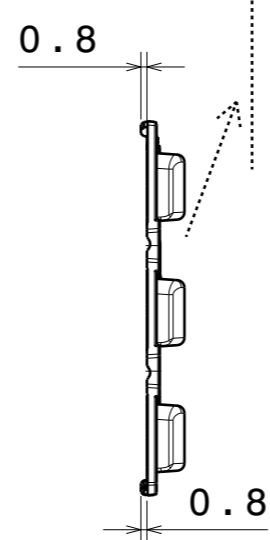
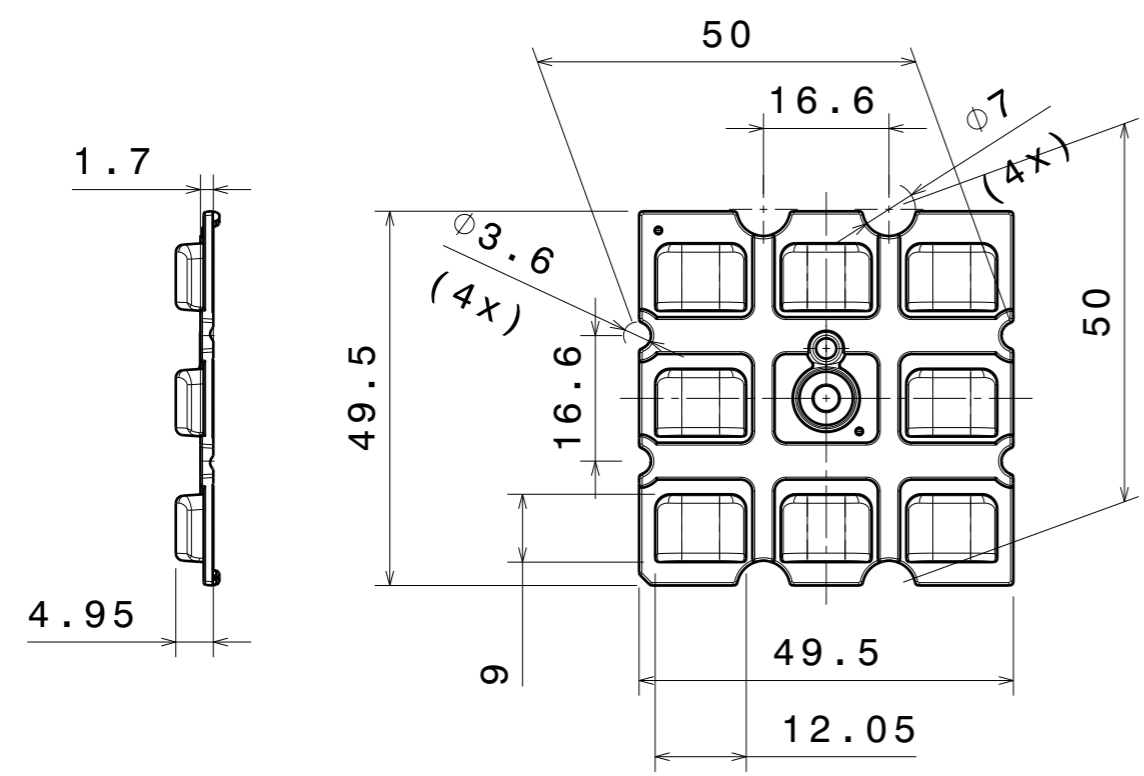

2x16,6=33.2  
(LED center)

Led location x8

Location pin cc

Note:  
Center screw recommended fixing torque 0,6Nm

Detail B  
Scale: 2:1  
Location Pin

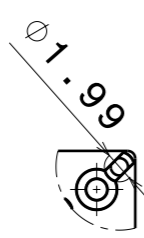

Detail A  
Scale: 2:1  
Location Pin

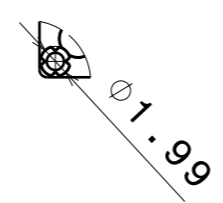

2x Min. 2.00mm hole to pcb

| INDEX | PART NO | DESCRIPTION       | MATERIAL | COLOUR |
|-------|---------|-------------------|----------|--------|
| 1     | C15982  | STRADELLA-8-HV-T3 | PMMA     | clear  |

Tolerances if not otherwise shown  
According to DIN ISO 2768-1  
Linear measures:  
up to 30mm class M, otherwise class C  
According to DIN ISO 2768-2  
Form and position: class L

**LEDiL**

FIRST ANGLE PROJECTION:

DRAWING TITLE  
**C15982\_STRADELLA-8-HV-T3**

This drawing is the property of LEDiL Oy. It may not be reproduced, copied or communicated without a written agreement with LEDiL Oy.

SIZE PART NUMBER  
**A3 C15982**

SCALE 1:1 WEIGHT SHEET 1/1

H G B A

1

1

2

2

3

3

4

4

Luminaire: Ledil Oy C15982\_STRADELLA-8-HV-T3\_SIMULATED  
Lamps: 1 x Cree\_XP-G3

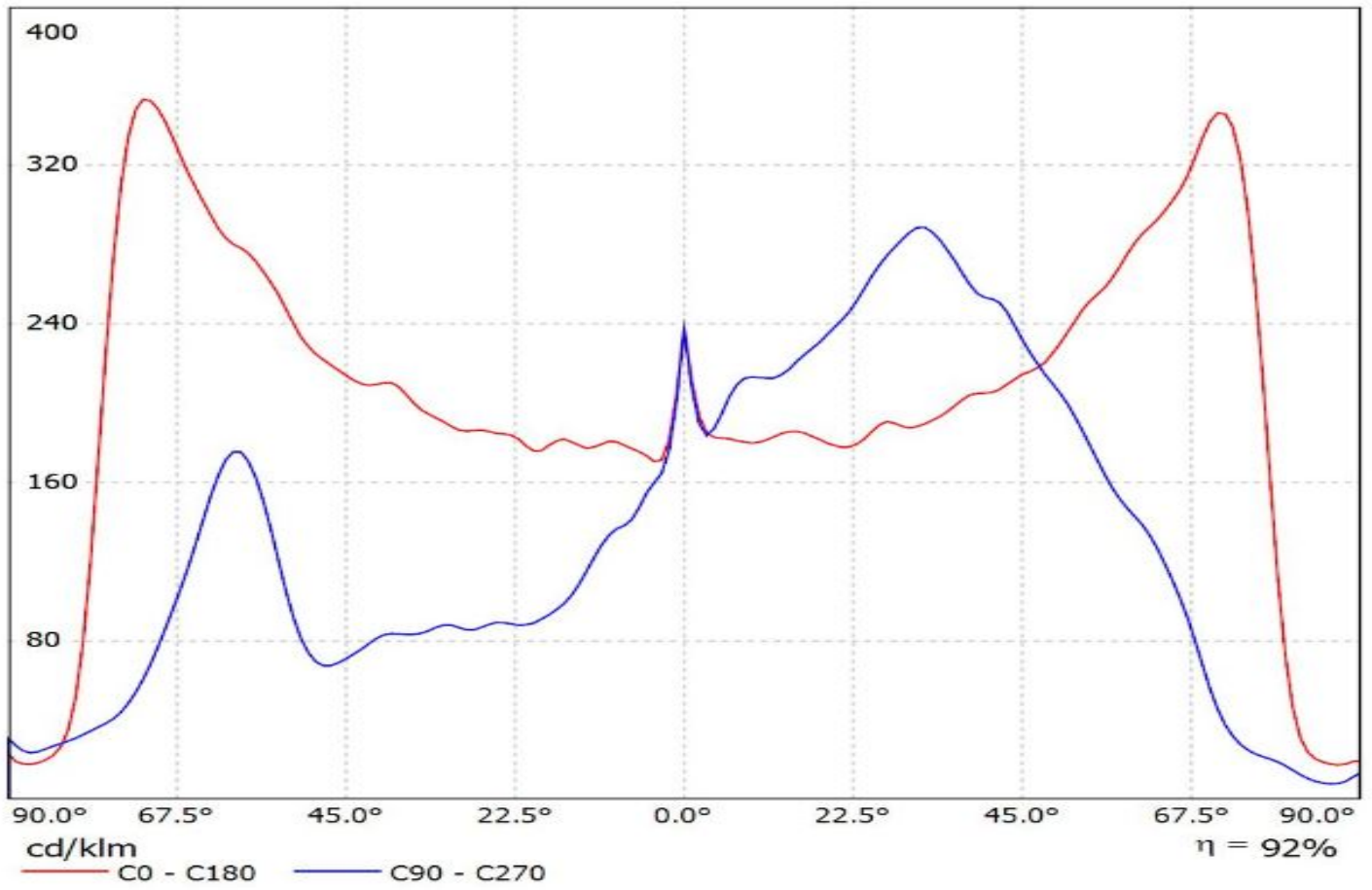

Luminaire: Ledil C15982\_STRADELLA-8-HV-T3\_(XD16)

Lamps: 1 x Cree\_XD16\_(XD16AWT-H-2B0-S20-0B-002)\_903.058lm@250mA\_CCT=5700K\_P5.51704=W\_I=0.250A

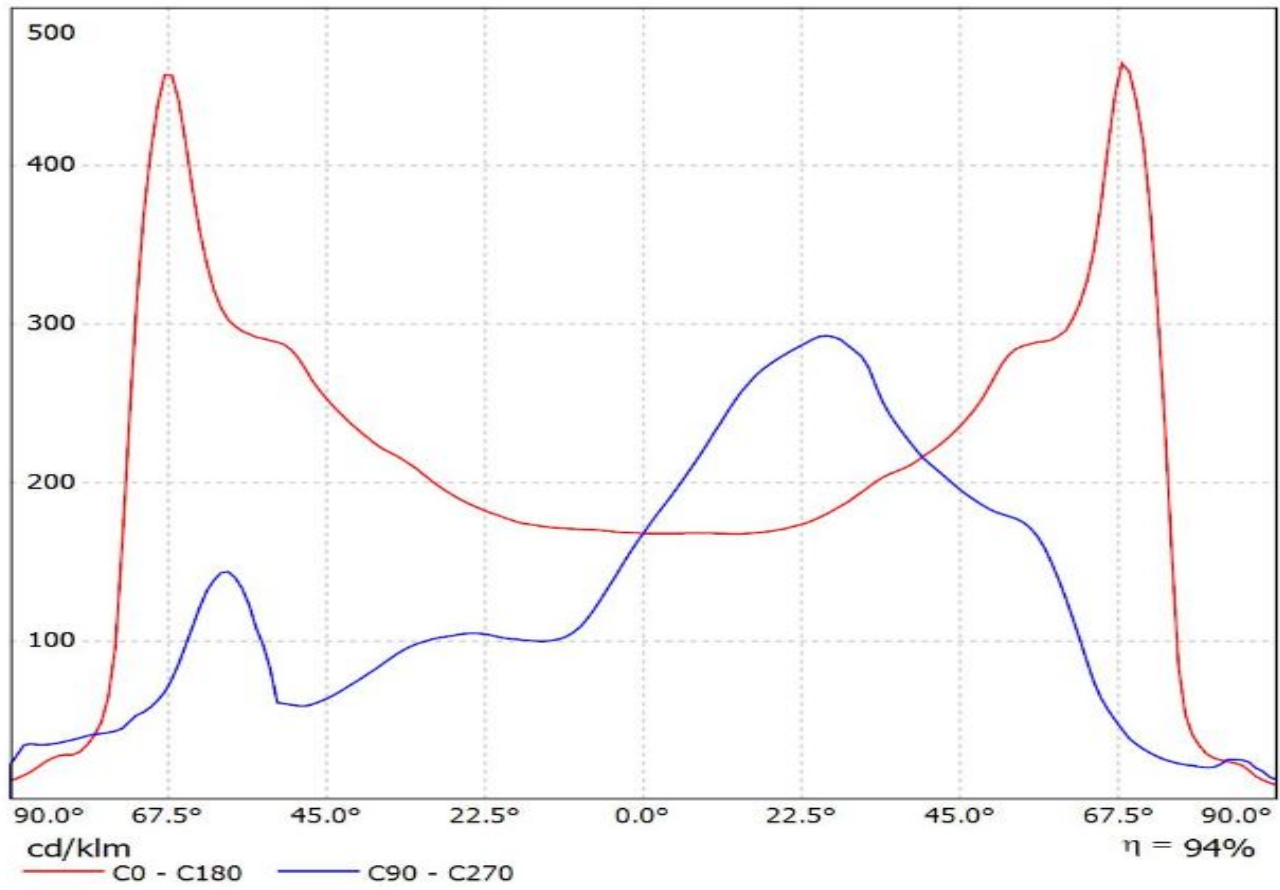

Luminaire: Ledil Oy C15982\_STRADELLA-8-HV-T3\_(NVSxx19C)\_SIMULATED  
Lamps: 1 x Nichia NVSL219C

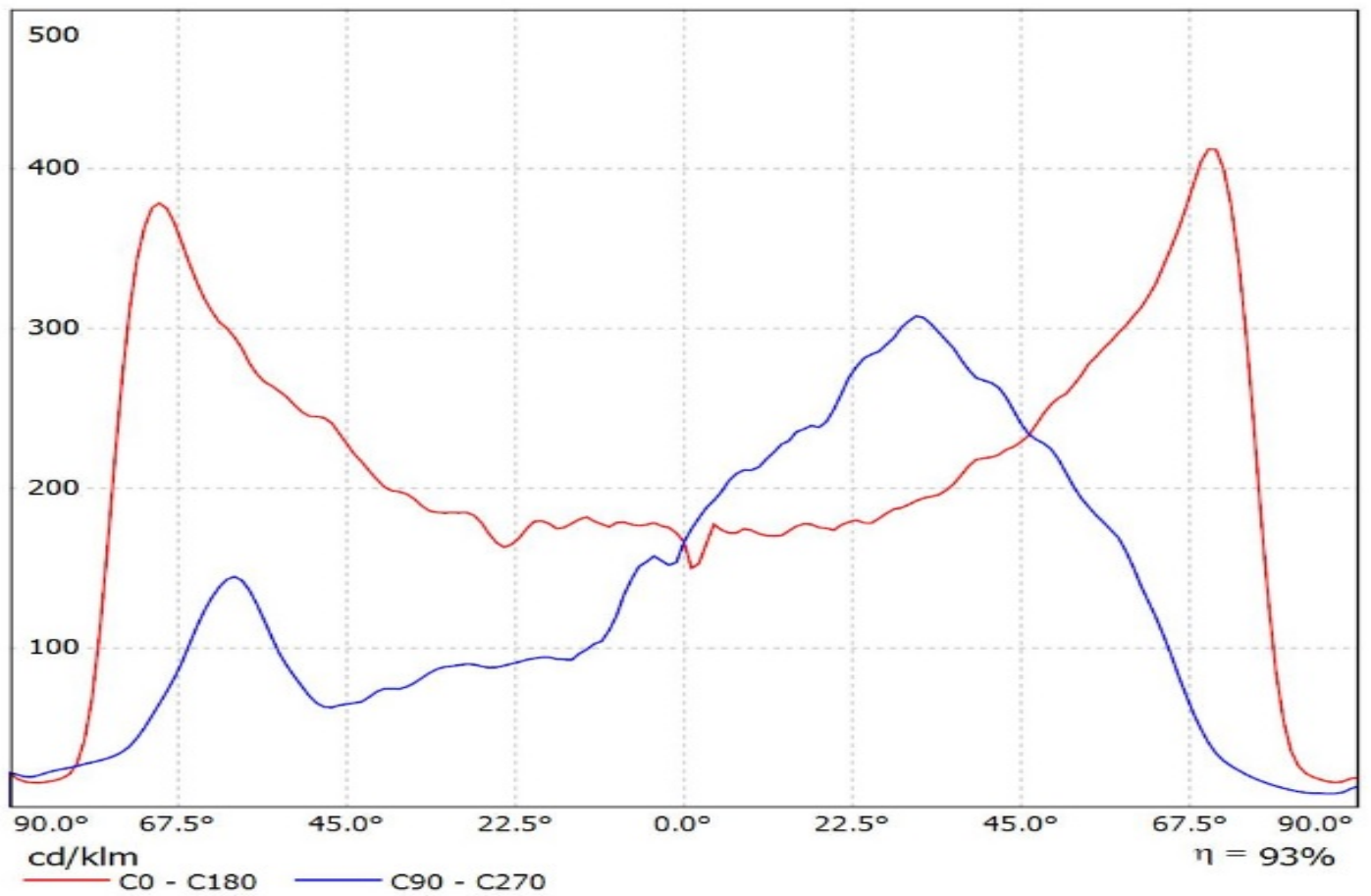

Luminaire: Ledil Oy C15982\_STRADELLA-8-HV-T3\_(NVSxx19C)\_(glass)\_SIMULATED  
Lamps: 1 x Nichia NVSL219C

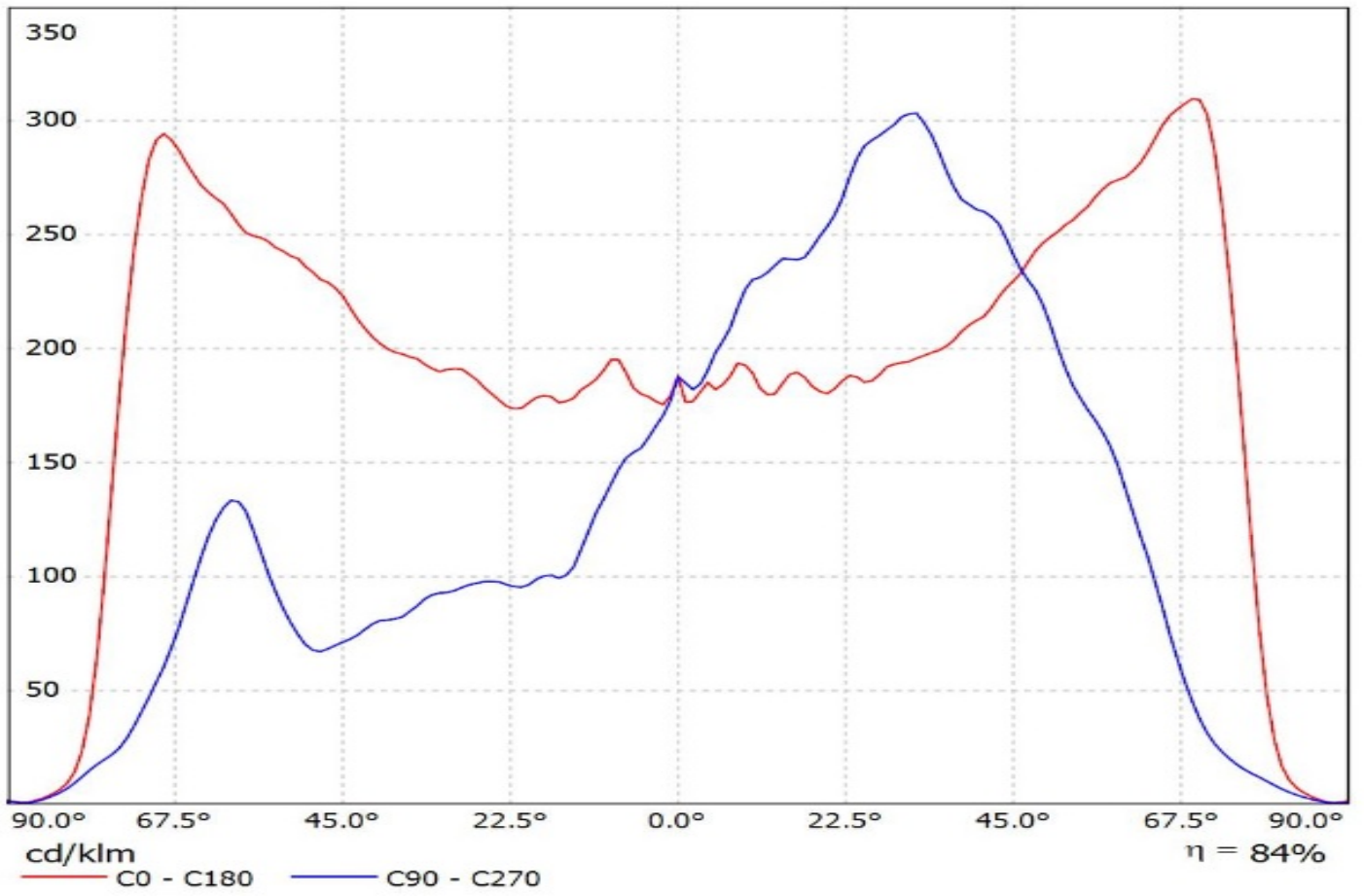

Luminaire: Ledil Oy C15982\_STRADELLA-8-HV-T3\_(LH181A)\_SIMULATED  
Lamps: 1 x Samsung LH181A

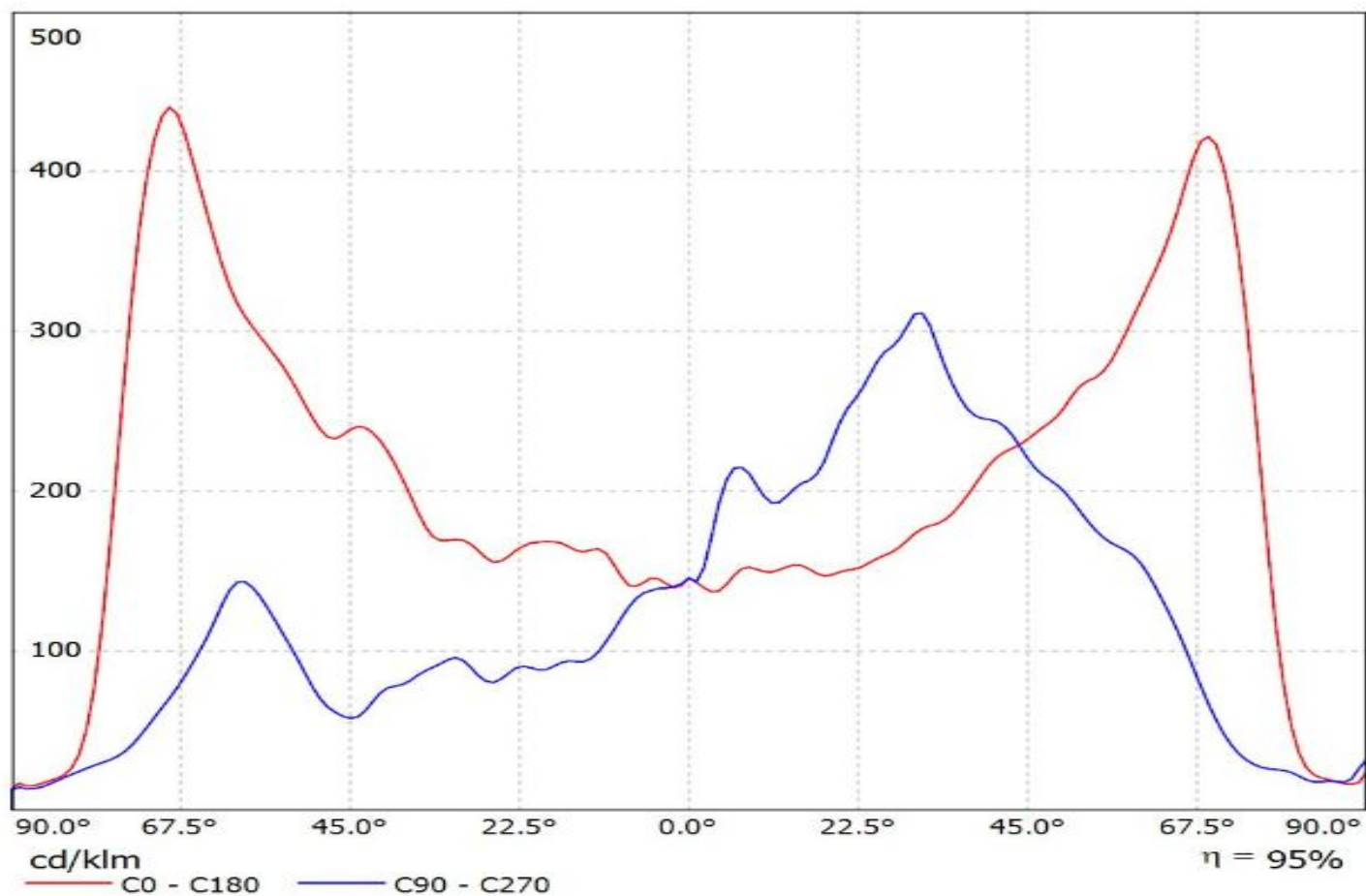

Luminaire: Ledil Oy C15982\_STRADELLA-8-HV-T3\_(LH181B)\_SIMULATED  
Lamps: 1 x Samsung LH181B

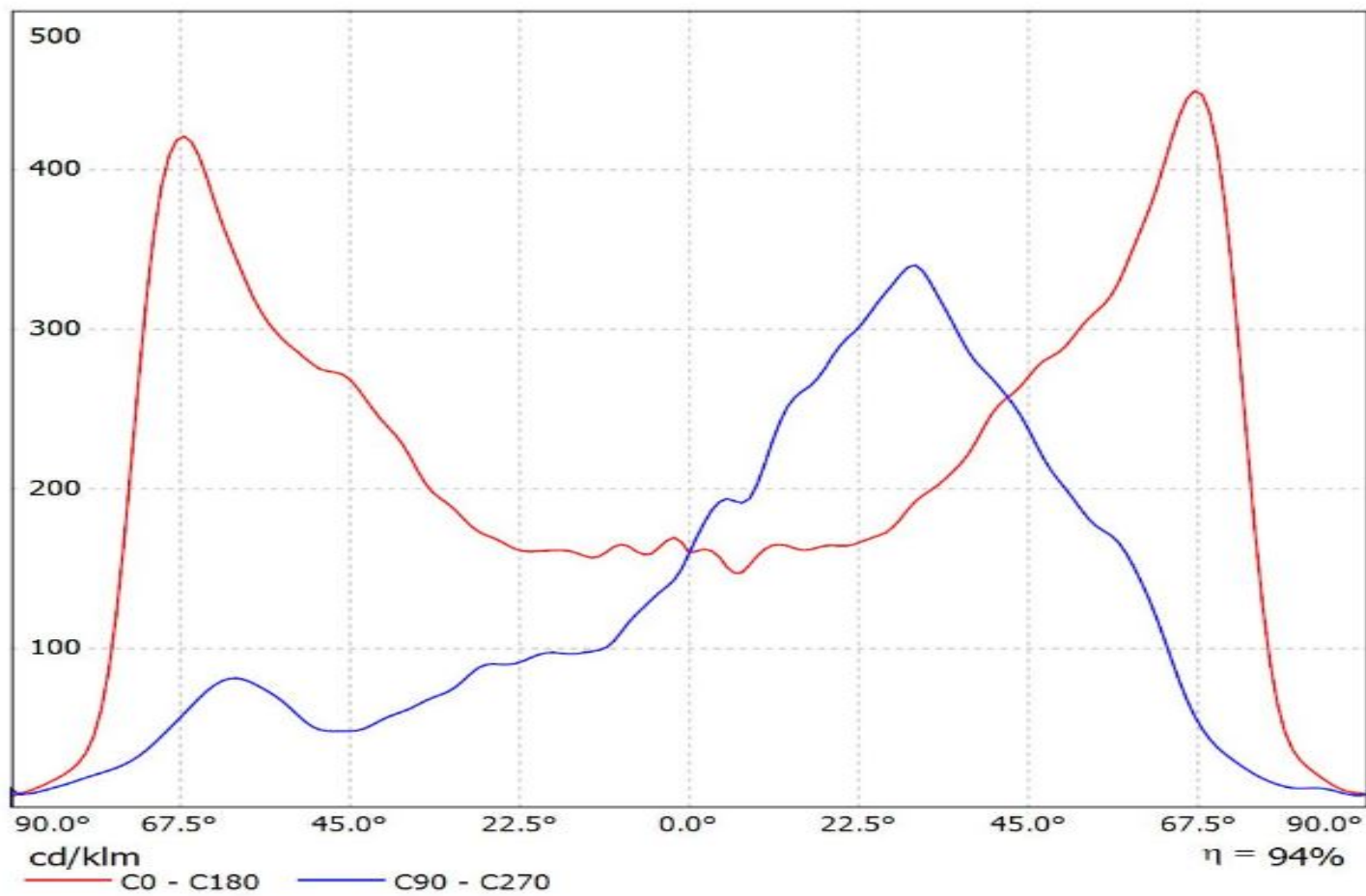

Luminaire: Ledil Oy C15982\_STRADELLA-8-HV-T3\_SIMULATED

Lamps: 1 x Cree\_XP-G3

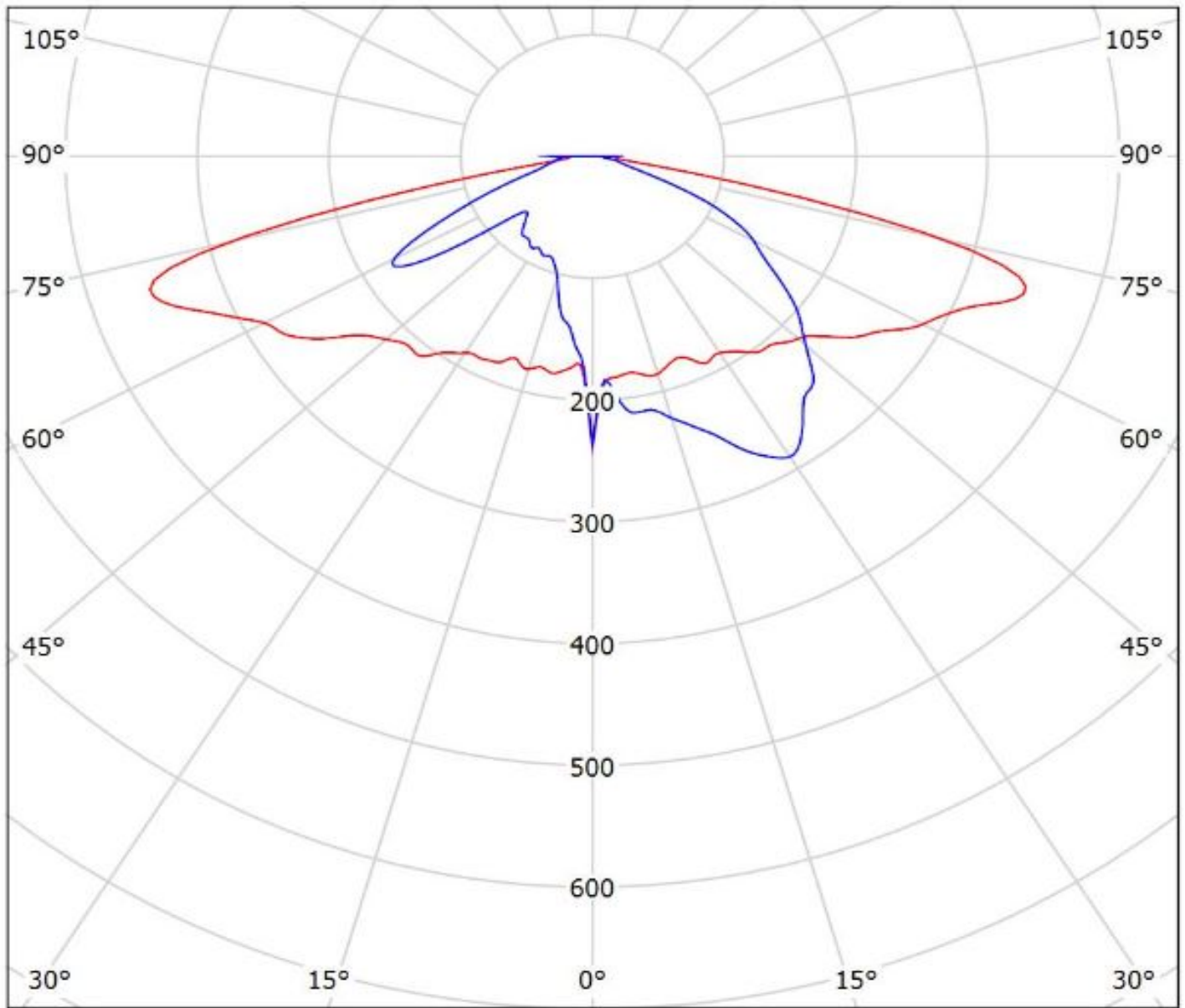

cd/klm

— C0 - C180 — C90 - C270

$\eta = 92\%$

Luminaire: Ledil C15982\_STRADELLA-8-HV-T3\_(XD16)

Lamps: 1 x Cree\_XD16\_(XD16AWT-H-2B0-S20-0B-002)\_903.058lm@250mA\_CCT=5700K\_P5.51704=W\_I=0.250A

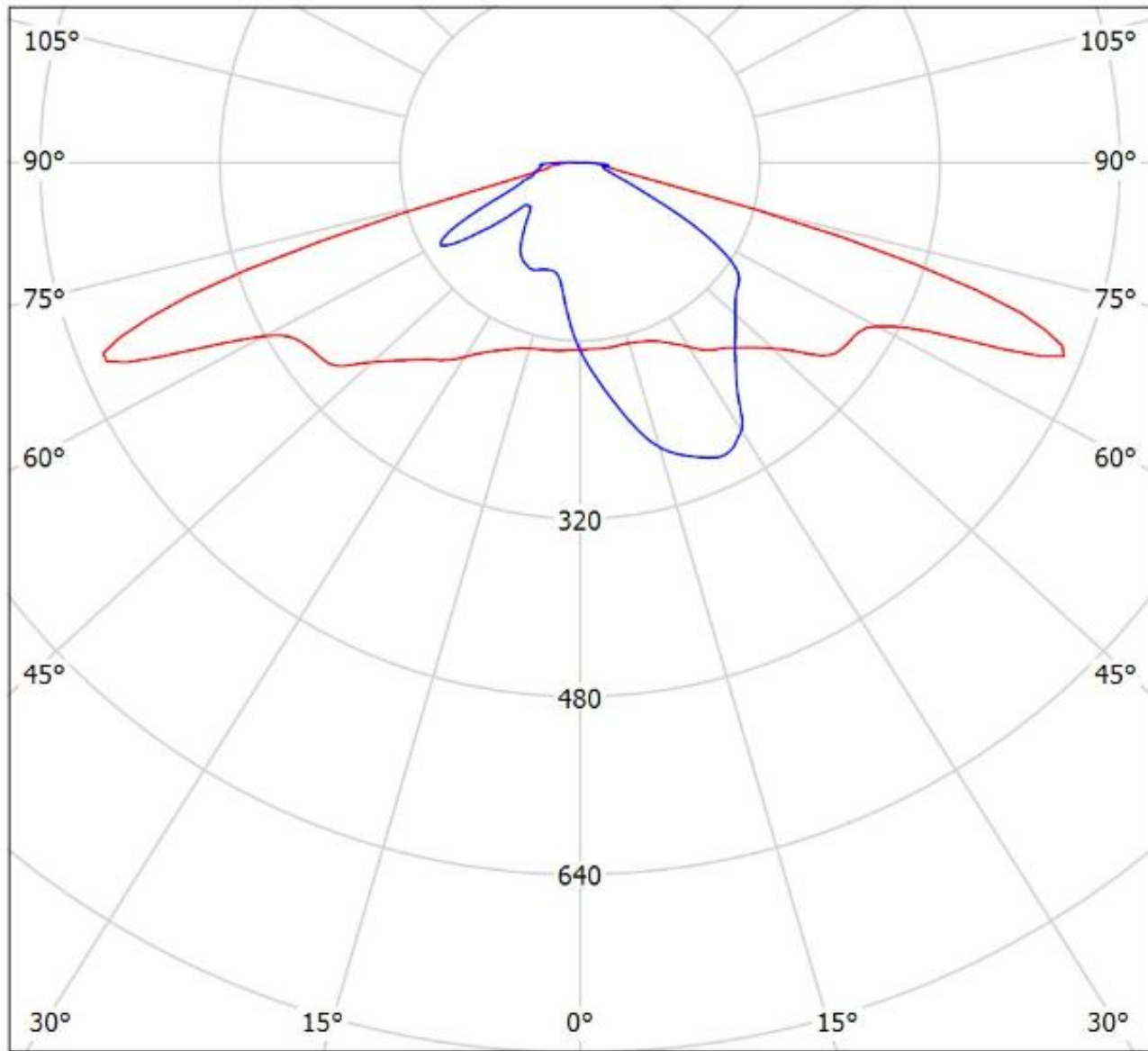

cd/klm

— C0 - C180 — C90 - C270

$\eta = 94\%$

Luminaire: Ledil Oy C15982\_STRADELLA-8-HV-T3\_(NVSxx19C)\_SIMULATED  
Lamps: 1 x Nichia NVSL219C

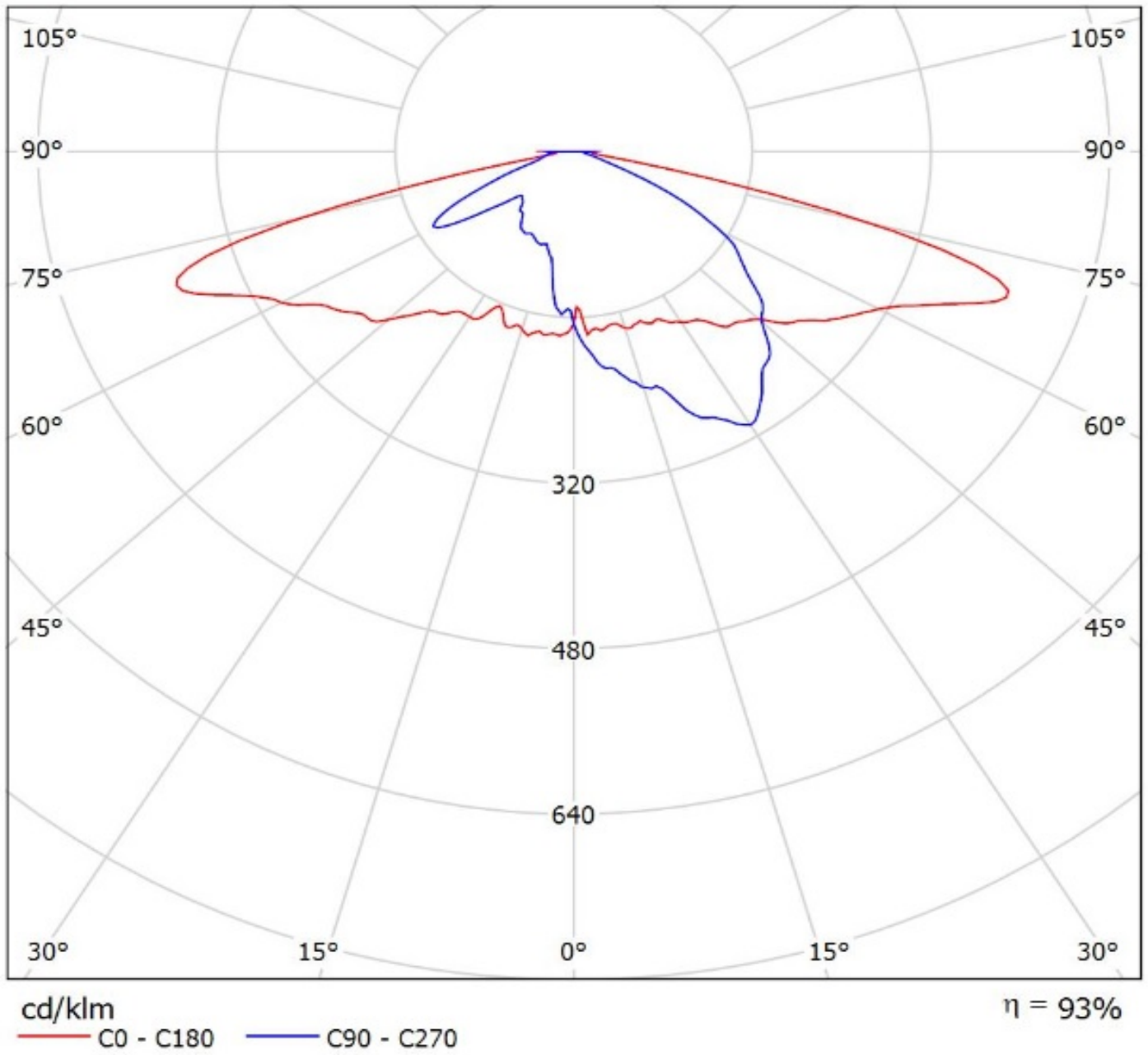

Luminaire: Ledil Oy C15982\_STRADELLA-8-HV-T3\_(NVSxx19C)\_(glass)\_SIMULATED  
Lamps: 1 x Nichia NVSL219C

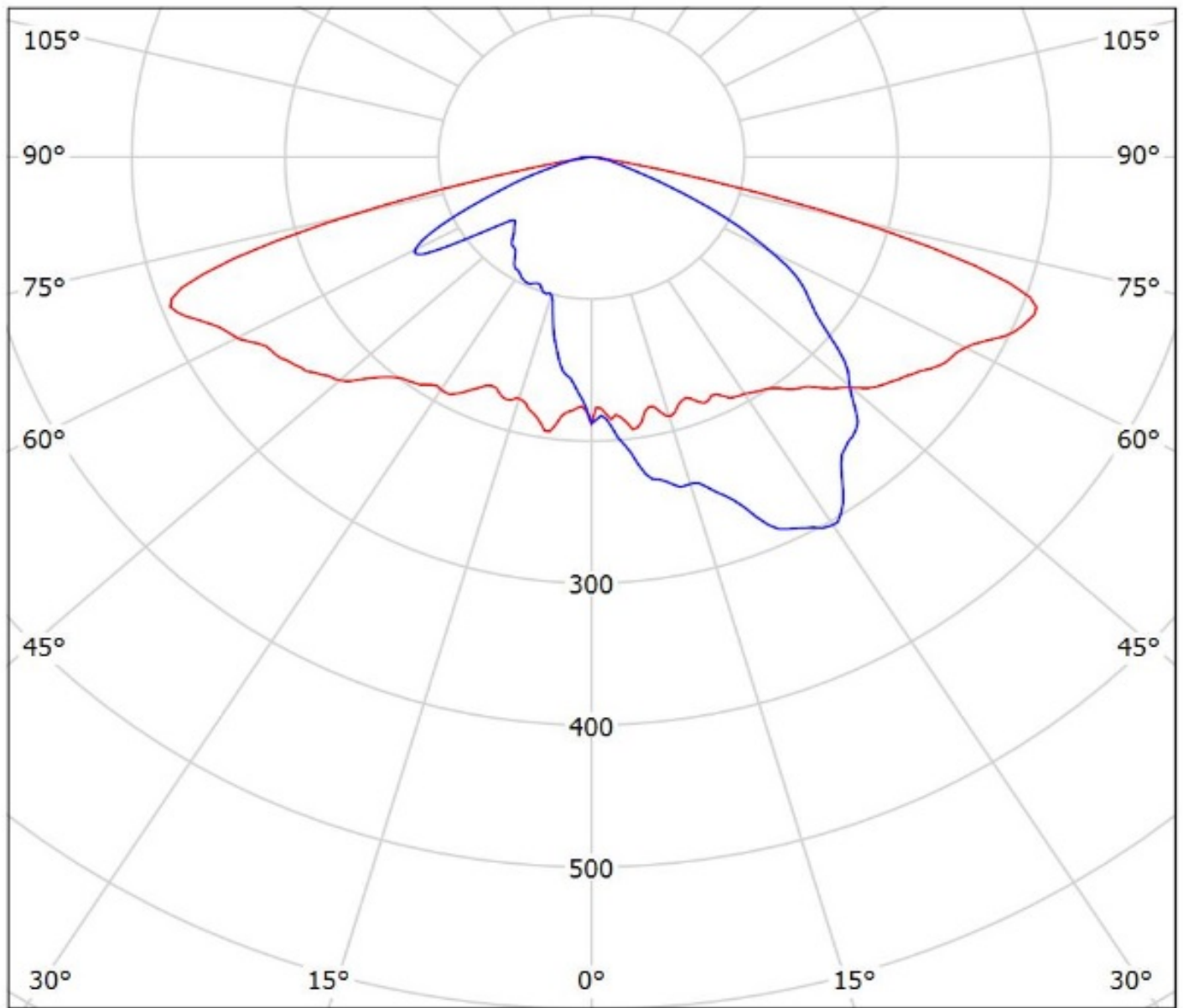

cd/klm

— C0 - C180 — C90 - C270

$\eta = 84\%$

Luminaire: Ledil Oy C15982\_STRADELLA-8-HV-T3\_(LH181A)\_SIMULATED  
Lamps: 1 x Samsung LH181A

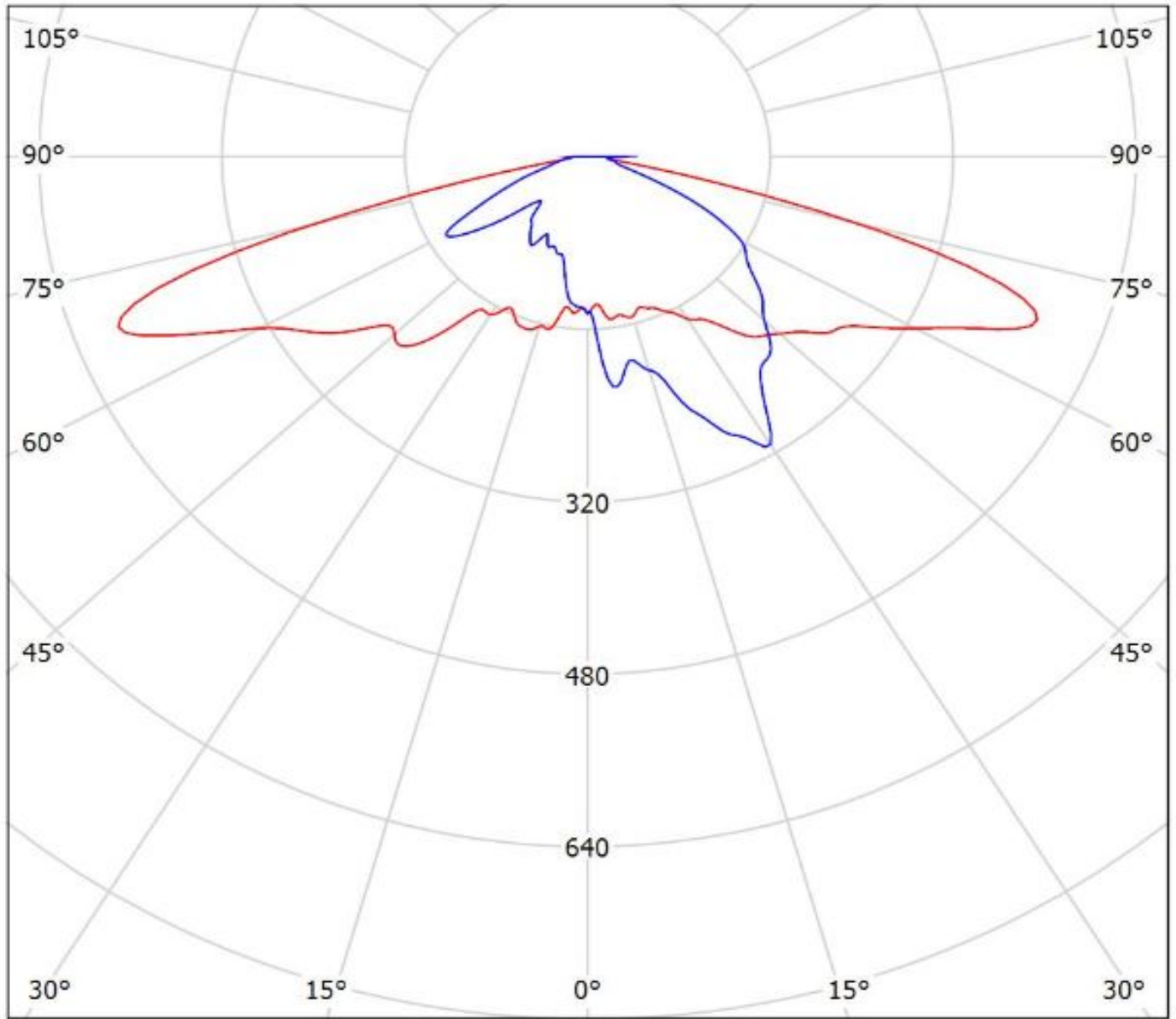

cd/klm  
— C0 - C180 — C90 - C270

$\eta = 95\%$

Luminaire: Ledil Oy C15982\_STRADELLA-8-HV-T3\_(LH181B)\_SIMULATED  
Lamps: 1 x Samsung LH181B

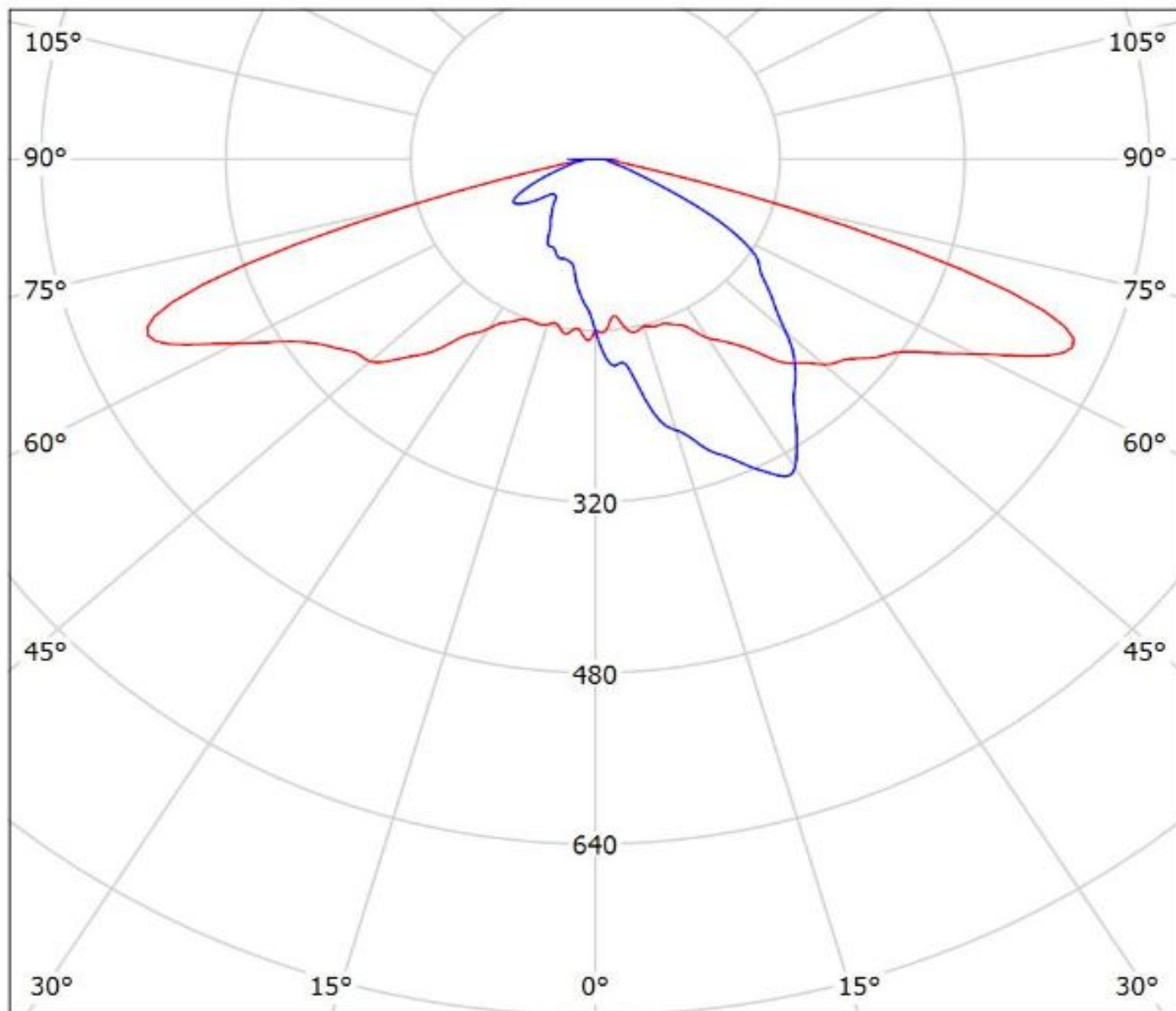

cd/klm

— C0 - C180 — C90 - C270

$\eta = 94\%$

**NOTE: The typical divergence will be changed by different color, chip size and chip position tolerance. The typical total divergence is the full angle measured where the luminous intensity is half of the peak value.**